



AC FIRE HSC SERIES 8100 FIRE PUMP PARTS DIAGRAMS



a xylem brand

Pump Model (Shaft Size)	Repack Kit	Minor Repair Kit	Major Repair Kit	Gasket Kit	60Hz Elect Sizes	Diesel Sizes
3x2x11F-S (1.500)	1DN203	1DN225	N/A	1DN243	100,150,200	100,150
6x4x9F (1.500)	1DN203	1DN211	1DN227	1DN243	500	500
6x4x10F-M (1.875)	1DN204	1DN211	1DN229	1DN246	500,750	500,750
6x4x11F (1.875)	1DN204	1DN211	1DN226	1DN246	1000	1000
6x4x12F-M (1.500)	1DN203	1DN211	1DN227	1DN243	500	500,750
6x6x9F (1.500)	1DN203	1DN211	1DN227	1DN245	750	500
8x6x9F (1.500)	1DN203	1DN211	1DN231	1DN245	1000	750
8x6x10F (1.875)	1DN204	1DN211	1DN228	1DN246	n/a	n/a
8x6x12F-S (1.500)	1DN204	1DN211	1DN231	1DN247	750,1000	500,750,1000
8x6x12F-M (1.875)	1DN204	1DN211	1DN226	1DN247	1250,1500	1250,1500
8x6x13F (1.875)	1DN204	1DN211	1DN244	1DN247	1000,1250	500-1500
8x6x18F (1.875)	1DN204	1DN211	1DN230	1DN247	1000,1250	750-1500
8x8x12F (1.875)	1DN204	1DN211	1DN254	1DN247	1250,1500	1250,1500,2000
8x8x17F (2.375)	1DN205	1DN211	1DN232	1DN248	1500	1,500
10x8x17F-S (2.375)	1DN205	1DN212	1DN222	1DN248	2000	2000
10x8x17F-L (2.375)	1DN205	1DN212	1DN222	1DN248	2500	2500
10x8x20F-S (2.375)	1DN205	1DN212	1DN223	1DN248	2000	1500,2000
10x8x20F-L (2.375)	1DN205	1DN212	1DN223	1DN248	2000,2500	2000,2500
12x10x18F (2.375)	1DN205	N/A	1DN224	1DN248	3000	2000,2500,3000

Reference Image of Rotating Assembly

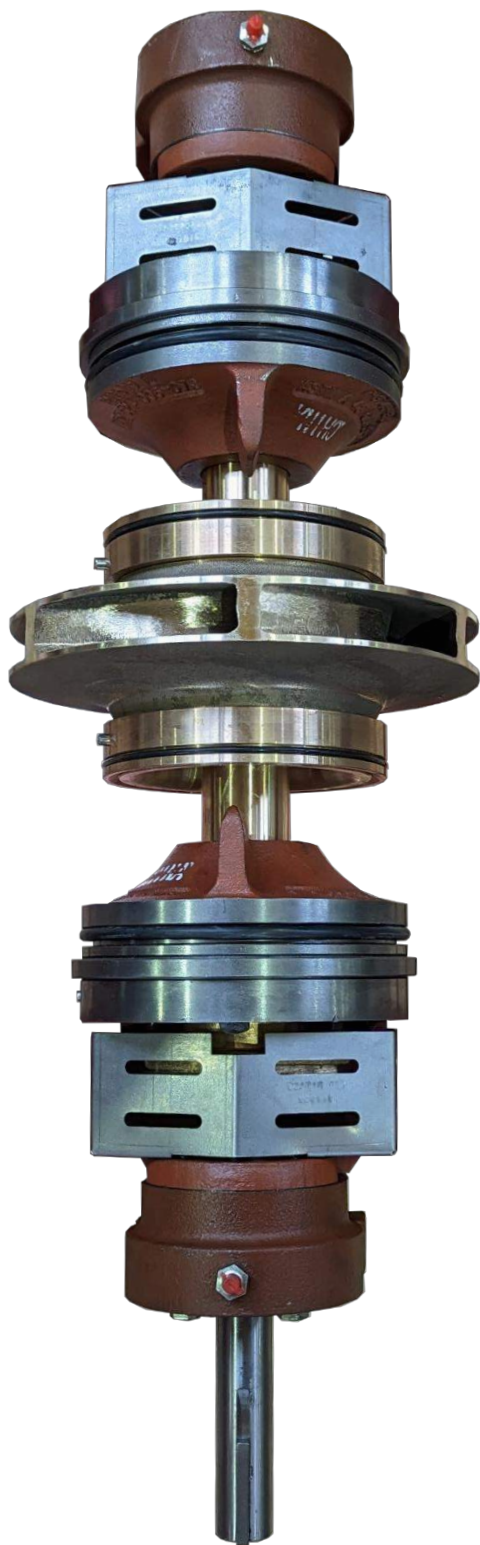

PRODUCT WARRANTY COVERAGE

A-C Fire Pump undertakes to remedy defects in their products under these conditions:

- The faults are due to defects in design, materials, or workmanship.
- The faults are reported to a local sales and service representative within the warranty period, as described in the Terms and Conditions of Sale provided with the Sales Contract.
- The product is used only under the conditions that are described in this manual.
- The monitoring equipment that is incorporated in the product is correctly connected and in use.
- All service and repair work is performed by qualified personnel.

LIMITATIONS

The warranty does not cover defects that are caused by these situations:

- Deficient maintenance.
- Improper installation.
- Modifications or changes to the product that are made without consulting an A-C Fire Pump authorized representative.
- Incorrectly executing repair work.
- Normal wear and tear.

A-C Fire Pump assumes no liability for these situations:

- Bodily injuries.
- Material damages.
- Economic losses.



PARTS LIST - AC FIRE SERIES 8100 / MODEL 3x2x11F-S (1.500" Shaft)

REV 0
DEC 2024

Always provide serial numbers when ordering parts. Factory can backcheck pump is not a custom build

Wear Surfaces same both sides. Quantities shown are totals for both sides.

Packing assembly same both sides

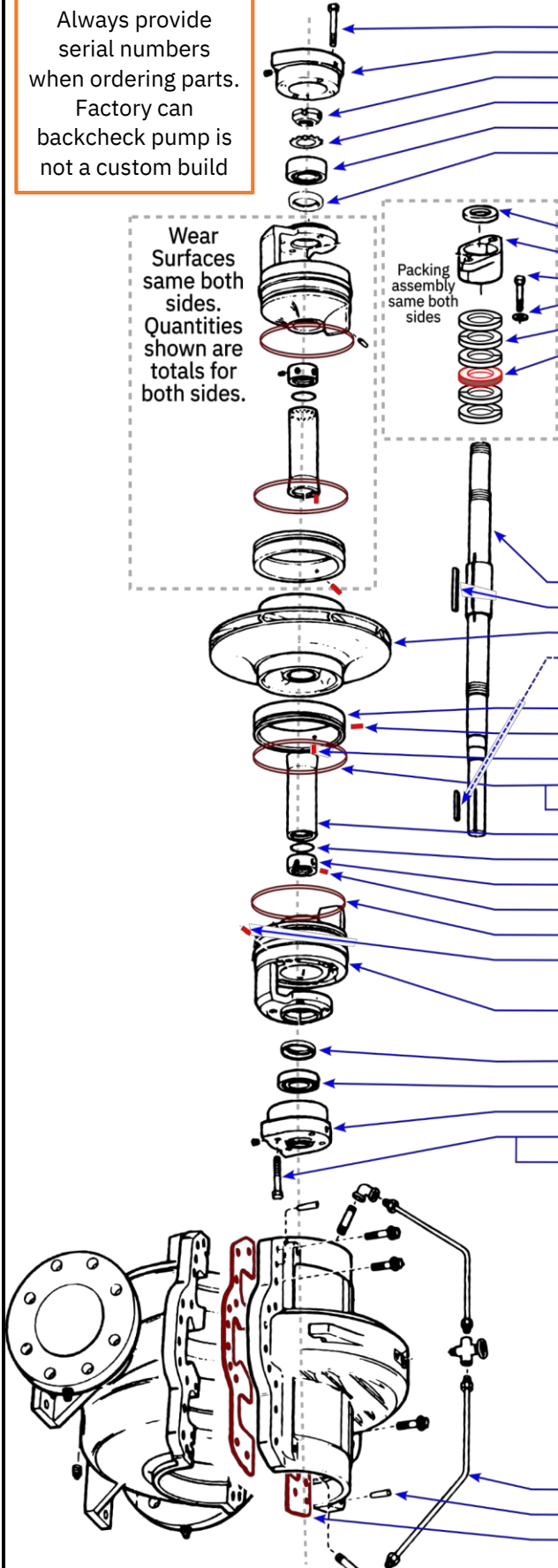

OUTBOARD BEARING ASSEMBLY				KITS		
Item No.	Part Number	Qty.	Description	1	2	3
3-904-9	CP-611-271-482	4	SCREW (BEARING HSG - OUT)			
3-025-4	52-239-563-001A	1	BEARING HOUSING (OUTBOARD)			
3-516-4	CP-819-111-206	1	LOCKNUT (BEARING)			
3-517-4	CP-819-133-206	1	LOCKWASHER (BEARING)			
3-026-4	CP-811-443-227	1	BEARING (OUTBOARD)		2	3
3-177-9	CP-753-030-535	1	LIP SEAL (same both sides)		2	3
3-449-9	N/A	-	BAFFLE (OUTBOARD)			
PACKING						
3-136-9	52-117-840-002	2	DEFLECTOR (Water Slinger)		2	3
1-014-9	52-224-259-501A	2	PACKING GLAND - HALF			
1-904-9	CP-611-327-472	4	GLAND SCREW	1	2	3
1-909-9	CP-651-001-214	4	GLAND WASHER	1	2	3
1-013-9	AC6128	12	SEAL CAGE (Lantern Ring) - OPTIONAL	1	2	3
1-924-9	52-430-298-017	2	PACKING RING	1	2	3
KITS - ITEMS INCLUDED WITH A KIT CANNOT BE ORDERED INDIVIDUALLY						
REPACK (1)	1DN203	-	REPACKING KIT	1		
MINOR (2)	1DN225	-	MINOR REPAIR KIT (INCLUDES REPACKING KIT)		2	
MAJOR (3)	N/A	-	MAJOR REPAIR KIT (INCLUDES MINOR REPAIR KIT)			3
SHAFT AND IMPELLER						
3-000-7	AC2728	1	SHAFT - STEEL 1045			
3-911-1	CP-677-103-183	1	KEY (IMPELLER)			
4-002-0	52-235-573-001	1	IMPELLER			
3-911-2	AC0522	1	KEY (COUPLING)			
WEAR SURFACES (IDENTICAL BOTH SIDES)						
3-003-9	52-117-232-501	2	CASING WEAR RING ASSEMBLY			3
3-943-9	CP-671-181-371	2	SPIROL PIN (CASING RING)			
0-944-0	52-114-088-007	2	LOCKPIN (SHAFT SLEEVE)			
3-914-2	CP-751-531-924	2	O-RING (CASING RING)		2	3
3-914-2	N/A	-	O-RING (CASING RING)		2	3
3-009-9	52-239-532-501	2	SHAFT SLEEVE			3
3-914-9	CP-751-531-428	2	O-RING (SLEEVE)		2	3
3-015-9	CP-617-039-366	2	SHAFT NUT (SLEEVE)			3
3-902-3	52-128-640-001	2	SET SCREW (SHAFT NUT)			3
3-914-1	CP-751-531-954	2	O-RING (STUFF BOX)		2	3
3-943-9	CP-671-181-371	2	SPIROL PIN (STUFF BOX)			
-	AC6394	2	SPIROL BOX SHAFT GUARD			
3-073-9	52-427-336-501A	2	STUFF BOX ASSEMBLY W/ PIN			
INBOARD BEARING ASSEMBLY						
3-177-9	CP-753-030-535	1	LIP SEAL (Identical to Outboard side)			
3-026-3	52-113-300-006	1	BEARING (INBOARD)		2	3
3-025-3	52-239-562-001A	1	BEARING HOUSING (INBOARD)			
3-904-9	CP-611-271-482	4	SCREW (BEARING HSG - INB, ELECTRIC)			
3-904-9	DJ0081	4	SCREW (BEARING HSG - INB, DIESEL)			
3-449-9	N/A	-	BAFFLE (INBOARD)			
3-449-9	N/A	-	BAFFLE SCREWS - IN- AND OUT-BOARD			
CASING						
2-001-0	52-116-916-521	1	CASING - 125# x 250#			
2-001-0	52-116-916-520	1	CASING - 250# x 250#			
2-001-0	52-116-916-501	1	CASING - 125# x 125#			
2-904-1	CP-611-314-613	4	CAPSCREW - CASING			
2-904-1	CP-611-314-616	8	CAPSCREW - CASING			
2-904-1	N/A	-	CAPSCREW - CASING			
2-904-1	CP-617-511-688	4	CAPSCREW - (H) CASING			
2-904-2	CP-617-511-689	8	CAPSCREW - (H) CASING			
2-904-3	N/A	-	CAPSCREW - (H) CASING			
0-952-0	52-127-292-502	1	SEAL PIPING			
2-916-1	CP-671-139-491	2	CASING TAPER PIN			
2-123-5	52-117-348-005	1	CASING GASKET - SUCTION	1	2	3
2-123-6	52-117-347-005	1	CASING GASKET - DISCHARGE	1	2	3



PARTS LIST - AC FIRE SERIES 8100 / MODEL 6x4x9F (1.500" Shaft)

REV 0
DEC 2024

Always provide serial numbers when ordering parts. Factory can backcheck pump is not a custom build

Wear Surfaces same both sides. Quantities shown are totals for both sides.

Packing assembly same both sides

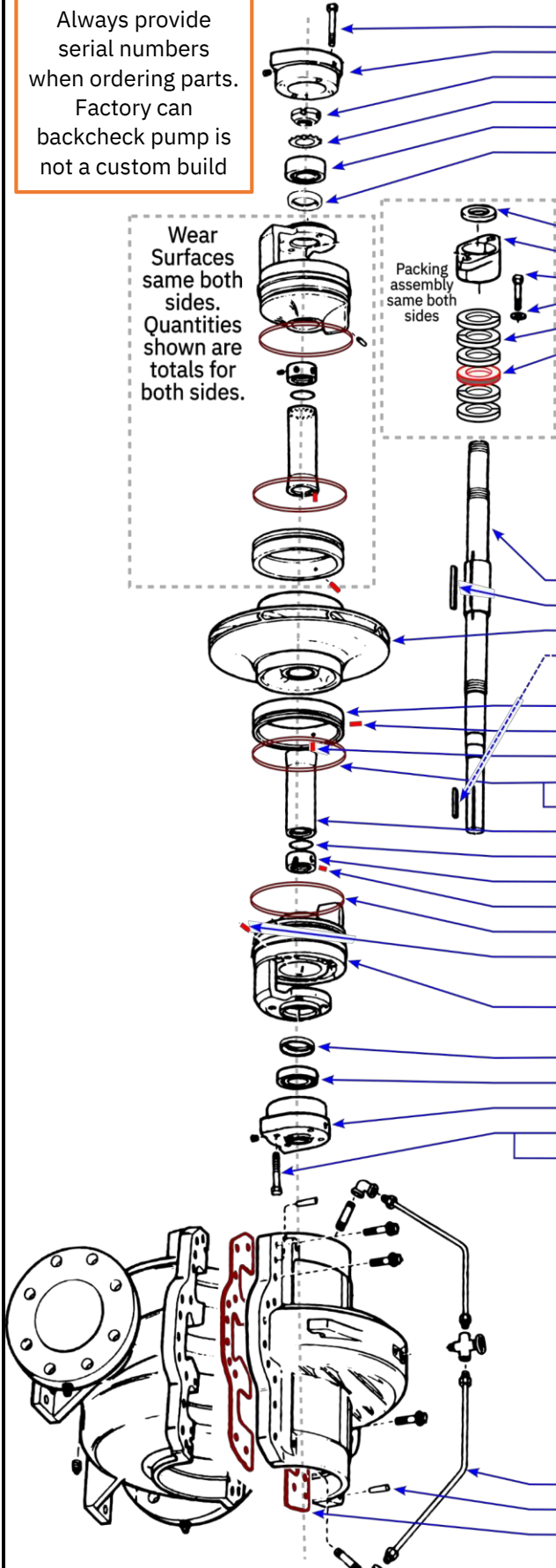

OUTBOARD BEARING ASSEMBLY				KITS		
Item No.	Part Number	Qty.	Description	1	2	3
3-904-9	CP-611-271-482	4	SCREW (BEARING HSG - OUT)			
3-025-4	52-239-563-001A	1	BEARING HOUSING (OUTBOARD)			
3-516-4	CP-819-111-206	1	LOCKNUT (BEARING)			
3-517-4	CP-819-133-206	1	LOCKWASHER (BEARING)			
3-026-4	CP-811-443-227	1	BEARING (OUTBOARD)		2	3
3-177-9	CP-753-030-535	1	LIP SEAL (same both sides)		2	3
3-449-9	52-261-625-001	1	BAFFLE (OUTBOARD)			
PACKING						
3-136-9	52-117-840-002	2	DEFLECTOR (Water Slinger)		2	3
1-014-9	52-224-259-501A	2	PACKING GLAND - HALF			
1-904-9	CP-611-327-472	4	GLAND SCREW	1	2	3
1-909-9	CP-651-001-214	4	GLAND WASHER	1	2	3
1-013-9	AC6128	12	SEAL CAGE (Lantern Ring) - OPTIONAL	1	2	3
1-924-9	52-430-298-017	2	PACKING RING	1	2	3
KITS - ITEMS INCLUDED WITH A KIT CANNOT BE ORDERED INDIVIDUALLY						
REPACK (1)	1DN203	-	REPACKING KIT	1		
MINOR (2)	1DN211	-	MINOR REPAIR KIT (INCLUDES REPACKING KIT)		2	
MAJOR (3)	1DN227	-	MAJOR REPAIR KIT (INCLUDES MINOR REPAIR KIT)			3
SHAFT AND IMPELLER						
3-000-7	AC2731	1	SHAFT - STEEL 1045			
3-911-1	CP-677-103-183	1	KEY (IMPELLER)			
4-002-0	52-460-750-001	1	IMPELLER			
3-911-2	AC0522	1	KEY (COUPLING)			
WEAR SURFACES (IDENTICAL BOTH SIDES)						
3-003-9	52-117-118-501	2	CASING WEAR RING ASSEMBLY			3
3-943-9	CP-671-181-371	2	SPIROL PIN (CASING RING)			
0-944-0	52-114-088-007	2	LOCKPIN (SHAFT SLEEVE)			
3-914-2	CP-751-531-932	2	O-RING (CASING RING)		2	3
3-914-2	N/A	-	O-RING (CASING RING)		2	3
3-009-9	52-239-536-501	2	SHAFT SLEEVE			3
3-914-9	CP-751-531-428	2	O-RING (SLEEVE)		2	3
3-015-9	CP-617-039-366	2	SHAFT NUT (SLEEVE)			3
3-902-3	52-128-640-001	2	SET SCREW (SHAFT NUT)			3
3-914-1	CP-751-531-264	2	O-RING (STUFF BOX)		2	3
3-943-9	CP-671-181-371	2	SPIROL PIN (STUFF BOX)			
-	AC6394	2	SPIROL BOX SHAFT GUARD			
3-073-9	52-460-715-501A	2	STUFF BOX ASSEMBLY W/ PIN			
INBOARD BEARING ASSEMBLY						
3-177-9	CP-753-030-535	1	LIP SEAL (Identical to Outboard side)			
3-026-3	52-113-300-006	1	BEARING (INBOARD)		2	3
3-025-3	52-239-562-001A	1	BEARING HOUSING (INBOARD)			
3-904-9	CP-611-271-482	4	SCREW (BEARING HSG - INB, ELECTRIC)			
3-904-9	DJ0081	4	SCREW (BEARING HSG - INB, DIESEL)			
3-449-9	52-261-625-002	1	BAFFLE (INBOARD)			
3-449-9	CP-615-106-461	4	BAFFLE SCREWS - IN- AND OUT-BOARD			
CASING						
2-001-0	52-460-745-521	1	CASING - 125# x 250#			
2-001-0	52-460-745-520	1	CASING - 250# x 250#			
2-001-0	52-460-745-501	1	CASING - 125# x 125#			
2-904-1	J92017	4	CAPSCREW - CASING			
2-904-1	CP-611-314-615	13	CAPSCREW - CASING			3
2-904-1	N/A	-	CAPSCREW - CASING			
2-904-1	CP-617-511-688	4	CAPSCREW - (H) CASING			
2-904-2	CP-617-511-691	13	CAPSCREW - (H) CASING			
2-904-3	N/A	-	CAPSCREW - (H) CASING			
0-952-0	52-127-292-502	1	SEAL PIPING			
2-916-1	CP-671-139-491	2	CASING TAPER PIN			
2-123-5	52-260-248-005	1	CASING GASKET - SUCTION	1	2	3
2-123-6	52-260-249-005	1	CASING GASKET - DISCHARGE	1	2	3



PARTS LIST - AC FIRE SERIES 8100 / MODEL 6x4x10F-M (1.875" Shaft)

REV 0
DEC 2024

Always provide serial numbers when ordering parts. Factory can backcheck pump is not a custom build

Wear Surfaces same both sides. Quantities shown are totals for both sides.

Packing assembly same both sides

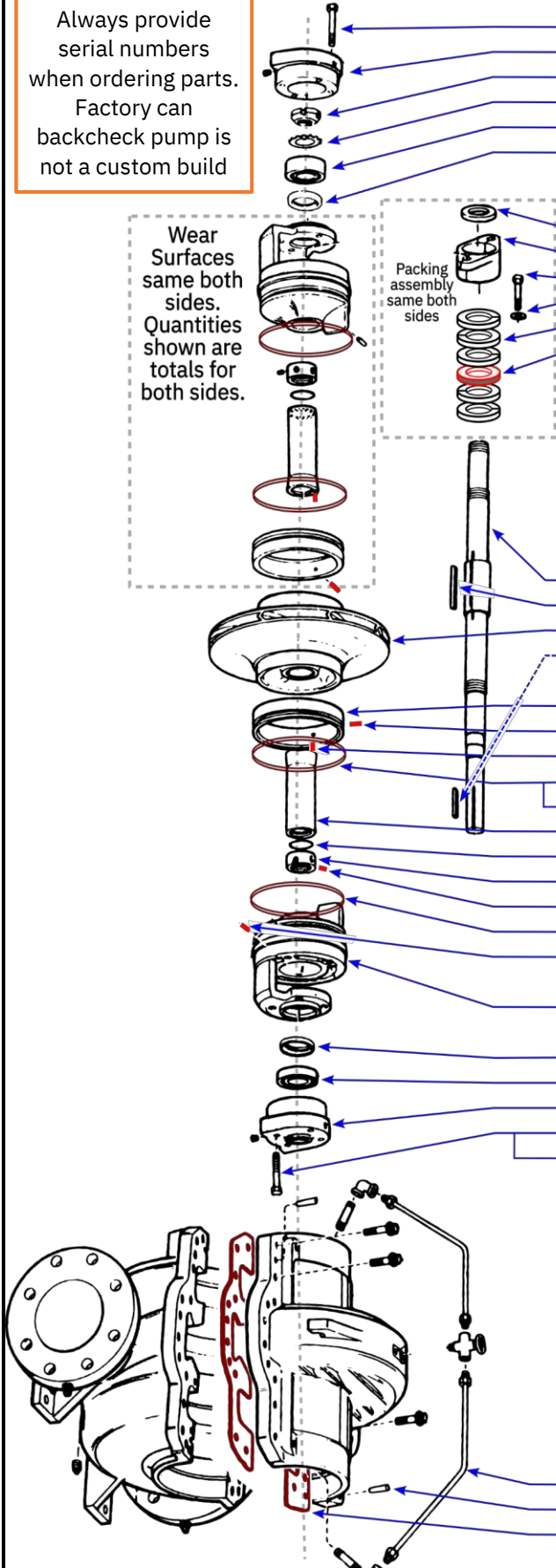

OUTBOARD BEARING ASSEMBLY				KITS		
Item No.	Part Number	Qty.	Description	1	2	3
3-904-9	CP-611-271-484	4	SCREW (BEARING HSG - OUT)			
3-025-4	52-239-567-001A	1	BEARING HOUSING (OUTBOARD)			
3-516-4	CP-819-111-207	1	LOCKNUT (BEARING)			
3-517-4	CP-819-133-207	1	LOCKWASHER (BEARING)			
3-026-4	CP-811-443-269	1	BEARING (OUTBOARD)		2	3
3-177-9	CP-753-030-907	1	LIP SEAL (same both sides)		2	3
3-449-9	N/A	-	BAFFLE (OUTBOARD)			
PACKING						
3-136-9	52-108-475-009	2	DEFLECTOR (Water Slinger)		2	3
1-014-9	08-104-772-501A	2	PACKING GLAND - HALF			
1-904-9	CP-611-327-552	4	GLAND SCREW	1	2	3
1-909-9	AC1502	4	GLAND WASHER	1	2	3
1-013-9	AC6129	12	SEAL CAGE (Lantern Ring) - OPTIONAL	1	2	3
1-924-9	52-430-298-028	2	PACKING RING	1	2	3
KITS - ITEMS INCLUDED WITH A KIT CANNOT BE ORDERED INDIVIDUALLY						
REPACK (1)	1DN204	-	REPACKING KIT	1		
MINOR (2)	1DN211	-	MINOR REPAIR KIT (INCLUDES REPACKING KIT)		2	
MAJOR (3)	1DN229	-	MAJOR REPAIR KIT (INCLUDES MINOR REPAIR KIT)			3
SHAFT AND IMPELLER						
3-000-7	52-239-343-005	1	SHAFT - STEEL 1045			
3-911-1	CP-677-051-146	1	KEY (IMPELLER)			
4-002-0	52-233-459-001	1	IMPELLER			
3-911-2	CP-677-103-191	1	KEY (COUPLING)			
WEAR SURFACES (IDENTICAL BOTH SIDES)						
3-003-9	52-117-418-501	2	CASING WEAR RING ASSEMBLY			3
3-943-9	CP-671-181-371	2	SPIROL PIN (CASING RING)			
0-944-0	52-114-088-007	2	LOCKPIN (SHAFT SLEEVE)			
3-914-2	CP-751-561-028	2	O-RING (CASING RING)		2	3
3-914-2	N/A	-	O-RING (CASING RING)		2	3
3-009-9	52-239-534-501	2	SHAFT SLEEVE			3
3-914-9	AC0545	2	O-RING (SLEEVE)		2	3
3-015-9	CP-617-039-366	2	SHAFT NUT (SLEEVE)			3
3-902-3	52-128-641-001	2	SET SCREW (SHAFT NUT)			3
3-914-1	CP-751-531-264	2	O-RING (STUFF BOX)		2	3
3-943-9	CP-671-181-371	2	SPIROL PIN (STUFF BOX)			
-	AC6395	2	SPIROL BOX SHAFT GUARD			
3-073-9	52-427-361-501A	2	STUFF BOX ASSEMBLY W/ PIN			
INBOARD BEARING ASSEMBLY						
3-177-9	CP-753-030-907	1	LIP SEAL (Identical to Outboard side)			
3-026-3	CP-811-005-293	1	BEARING (INBOARD)		2	3
3-025-3	52-239-566-001A	1	BEARING HOUSING (INBOARD)			
3-904-9	CP-611-271-484	4	SCREW (BEARING HSG - INB, ELECTRIC)			
3-904-9	CP-611-271-482	4	SCREW (BEARING HSG - INB, DIESEL)			
3-449-9	N/A	-	BAFFLE (INBOARD)			
3-449-9	N/A	-	BAFFLE SCREWS - IN- AND OUT-BOARD			
CASING						
2-001-0	52-116-917-523	1	CASING - 125# x 250#			
2-001-0	52-116-917-520	1	CASING - 250# x 250#			
2-001-0	52-116-917-501	1	CASING - 125# x 125#			
2-904-1	CP-611-314-613	6	CAPSCREW - CASING			
2-904-1	CP-611-314-617	4	CAPSCREW - CASING			
2-904-1	J92017	8	CAPSCREW - CASING			
2-904-1	CP-617-511-688	6	CAPSCREW - (H) CASING			
2-904-2	CP-617-511-690	4	CAPSCREW - (H) CASING			
2-904-3	CP-617-511-691	8	CAPSCREW - (H) CASING			
0-952-0	52-127-292-502	1	SEAL PIPING			
2-916-1	CP-671-139-491	2	CASING TAPER PIN			
2-123-5	52-117-415-005	1	CASING GASKET - SUCTION	1	2	3
2-123-6	52-117-414-005	1	CASING GASKET - DISCHARGE	1	2	3



PARTS LIST - AC FIRE SERIES 8100 / MODEL 6x4x11F (1.875" Shaft)

REV 0
DEC 2024

Always provide serial numbers when ordering parts. Factory can backcheck pump is not a custom build

Wear Surfaces same both sides. Quantities shown are totals for both sides.

Packing assembly same both sides

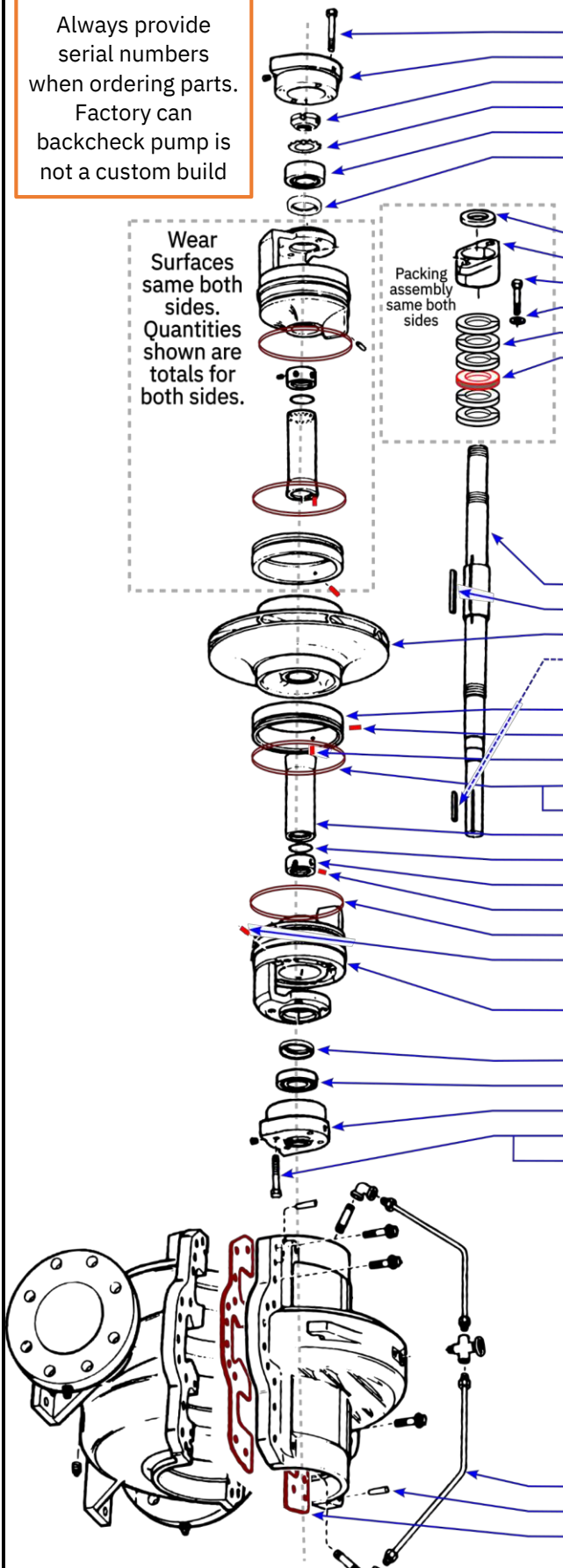

OUTBOARD BEARING ASSEMBLY				KITS		
Item No.	Part Number	Qty.	Description	1	2	3
3-904-9	CP-611-271-484	4	SCREW (BEARING HSG - OUT)			
3-025-4	52-239-567-001A	1	BEARING HOUSING (OUTBOARD)			
3-516-4	CP-819-111-207	1	LOCKNUT (BEARING)			
3-517-4	CP-819-133-207	1	LOCKWASHER (BEARING)			
3-026-4	CP-811-443-269	1	BEARING (OUTBOARD)		2	3
3-177-9	CP-753-030-907	1	LIP SEAL (same both sides)		2	3
3-449-9	52-235-844-001	1	BAFFLE (OUTBOARD)			
PACKING						
3-136-9	52-108-475-009	2	DEFLECTOR (Water Slinger)		2	3
1-014-9	08-104-772-501A	2	PACKING GLAND - HALF			
1-904-9	CP-611-327-552	4	GLAND SCREW	1	2	3
1-909-9	AC1502	4	GLAND WASHER	1	2	3
1-013-9	AC6129	12	SEAL CAGE (Lantern Ring) - OPTIONAL	1	2	3
1-924-9	52-430-298-028	2	PACKING RING	1	2	3
KITS - ITEMS INCLUDED WITH A KIT CANNOT BE ORDERED INDIVIDUALLY						
REPACK (1)	1DN204	-	REPACKING KIT	1		
MINOR (2)	1DN211	-	MINOR REPAIR KIT (INCLUDES REPACKING KIT)		2	
MAJOR (3)	1DN226	-	MAJOR REPAIR KIT (INCLUDES MINOR REPAIR KIT)			3
SHAFT AND IMPELLER						
3-000-7	52-239-343-005	1	SHAFT - STEEL 1045			
3-911-1	CP-677-051-146	1	KEY (IMPELLER)			
4-002-0	52-233-501-001	1	IMPELLER			
3-911-2	CP-677-103-191	1	KEY (COUPLING)			
WEAR SURFACES (IDENTICAL BOTH SIDES)						
3-003-9	52-117-117-501	2	CASING WEAR RING ASSEMBLY			3
3-943-9	CP-671-181-371	2	SPIROL PIN (CASING RING)			
0-944-0	52-114-088-007	2	LOCKPIN (SHAFT SLEEVE)			
3-914-2	CP-751-531-937	2	O-RING (CASING RING)		2	3
3-914-2	N/A	-	O-RING (CASING RING)		2	3
3-009-9	52-239-534-501	2	SHAFT SLEEVE			3
3-914-9	AC0545	2	O-RING (SLEEVE)		2	3
3-015-9	CP-617-039-366	2	SHAFT NUT (SLEEVE)			3
3-902-3	52-128-641-001	2	SET SCREW (SHAFT NUT)			3
3-914-1	CP-751-531-264	2	O-RING (STUFF BOX)		2	3
3-943-9	CP-671-181-371	2	SPIROL PIN (STUFF BOX)			
-	AC6395	2	SPIROL BOX SHAFT GUARD			
3-073-9	52-235-854-001A	2	STUFF BOX ASSEMBLY W/ PIN			
INBOARD BEARING ASSEMBLY						
3-177-9	CP-753-030-907	1	LIP SEAL (Identical to Outboard side)			
3-026-3	CP-811-005-293	1	BEARING (INBOARD)		2	3
3-025-3	52-239-566-001A	1	BEARING HOUSING (INBOARD)			
3-904-9	CP-611-271-484	4	SCREW (BEARING HSG - INB, ELECTRIC)			
3-904-9	CP-611-271-482	4	SCREW (BEARING HSG - INB, DIESEL)			
3-449-9	52-235-844-001	1	BAFFLE (INBOARD)			
3-449-9	CP-611-327-422	2	BAFFLE SCREWS - IN- AND OUT-BOARD			
CASING						
2-001-0	52-123-957-522	1	CASING - 125# x 250#			
2-001-0	52-123-957-520	1	CASING - 250# x 250#			
2-001-0	52-123-957-501	1	CASING - 125# x 125#			
2-904-1	CP-611-314-613	6	CAPSCREW - CASING			
2-904-1	CP-611-314-617	4	CAPSCREW - CASING			
2-904-1	J92017	8	CAPSCREW - CASING			
2-904-1	CP-617-511-688	6	CAPSCREW - (H) CASING			
2-904-2	CP-617-511-690	4	CAPSCREW - (H) CASING			
2-904-3	CP-617-511-691	8	CAPSCREW - (H) CASING			
0-952-0	52-127-292-502	1	SEAL PIPING			
2-916-1	CP-671-139-491	2	CASING TAPER PIN			
2-123-5	52-235-515-005	1	CASING GASKET - SUCTION	1	2	3
2-123-6	52-235-514-005	1	CASING GASKET - DISCHARGE	1	2	3



PARTS LIST - AC FIRE SERIES 8100 / MODEL 6x4x12F-M (1.500" Shaft)

REV 0
DEC 2024

Always provide serial numbers when ordering parts. Factory can backcheck pump is not a custom build

Wear Surfaces same both sides. Quantities shown are totals for both sides.

Packing assembly same both sides

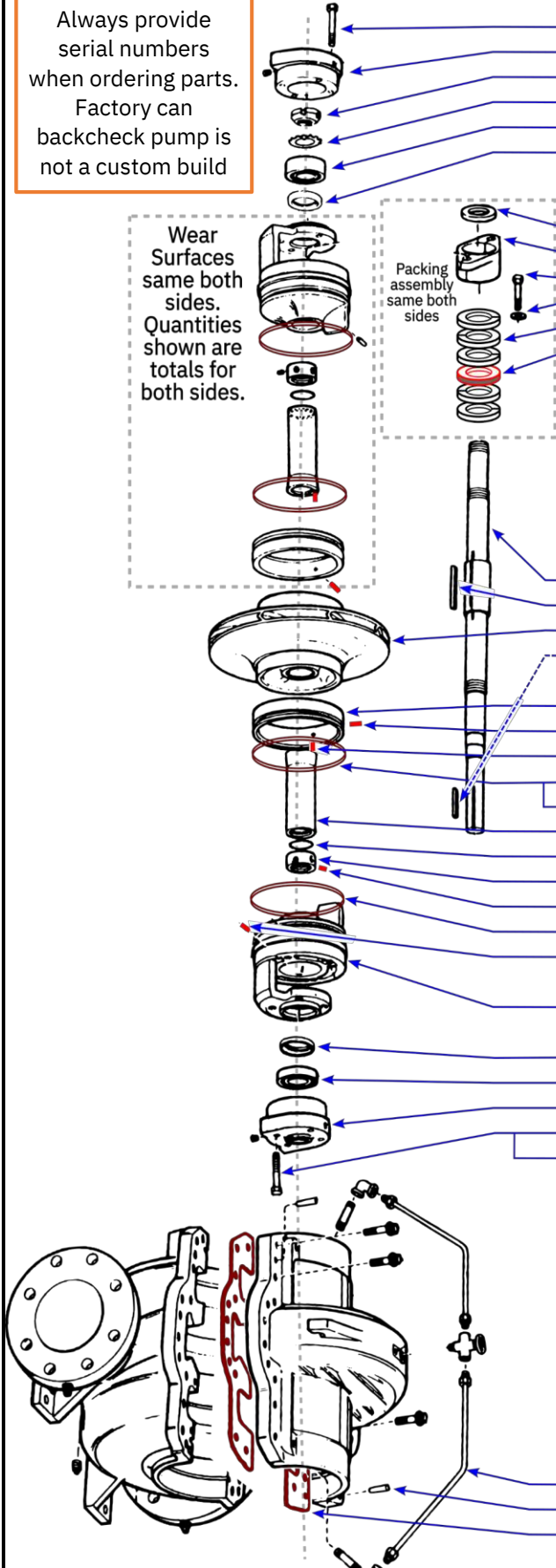

OUTBOARD BEARING ASSEMBLY				KITS		
Item No.	Part Number	Qty.	Description	1	2	3
3-904-9	CP-611-271-482	4	SCREW (BEARING HSG - OUT)			
3-025-4	52-239-563-001A	1	BEARING HOUSING (OUTBOARD)			
3-516-4	CP-819-111-206	1	LOCKNUT (BEARING)			
3-517-4	CP-819-133-206	1	LOCKWASHER (BEARING)			
3-026-4	CP-811-443-227	1	BEARING (OUTBOARD)		2	3
3-177-9	CP-753-030-535	1	LIP SEAL (same both sides)		2	3
3-449-9	N/A	-	BAFFLE (OUTBOARD)			
PACKING						
3-136-9	52-117-840-002	2	DEFLECTOR (Water Slinger)		2	3
1-014-9	52-224-259-501A	2	PACKING GLAND - HALF			
1-904-9	CP-611-327-472	4	GLAND SCREW	1	2	3
1-909-9	CP-651-001-214	4	GLAND WASHER	1	2	3
1-013-9	AC6128	12	SEAL CAGE (Lantern Ring) - OPTIONAL	1	2	3
1-924-9	52-430-298-017	2	PACKING RING	1	2	3
KITS - ITEMS INCLUDED WITH A KIT CANNOT BE ORDERED INDIVIDUALLY						
REPACK (1)	1DN203	-	REPACKING KIT	1		
MINOR (2)	1DN211	-	MINOR REPAIR KIT (INCLUDES REPACKING KIT)		2	
MAJOR (3)	1DN227	-	MAJOR REPAIR KIT (INCLUDES MINOR REPAIR KIT)			3
SHAFT AND IMPELLER						
3-000-7	52-239-345-008	1	SHAFT - STEEL 1045			
3-911-1	CP-677-103-183	1	KEY (IMPELLER)			
4-002-0	52-460-558-000	1	IMPELLER			
3-911-2	AC0522	1	KEY (COUPLING)			
WEAR SURFACES (IDENTICAL BOTH SIDES)						
3-003-9	52-117-118-501	2	CASING WEAR RING ASSEMBLY			3
3-943-9	CP-671-181-371	2	SPIROL PIN (CASING RING)			
0-944-0	52-114-088-007	2	LOCKPIN (SHAFT SLEEVE)			
3-914-2	CP-751-531-932	2	O-RING (CASING RING)		2	3
3-914-2	N/A	-	O-RING (CASING RING)		2	3
3-009-9	52-239-536-501	2	SHAFT SLEEVE			3
3-914-9	CP-751-531-428	2	O-RING (SLEEVE)		2	3
3-015-9	CP-617-039-366	2	SHAFT NUT (SLEEVE)			3
3-902-3	52-128-640-001	2	SET SCREW (SHAFT NUT)			3
3-914-1	CP-751-531-264	2	O-RING (STUFF BOX)		2	3
3-943-9	CP-671-181-371	2	SPIROL PIN (STUFF BOX)			
-	N/A	-	SPIROL BOX SHAFT GUARD			
3-073-9	52-427-285-501A	2	STUFF BOX ASSEMBLY W/ PIN			
INBOARD BEARING ASSEMBLY						
3-177-9	CP-753-030-535	1	LIP SEAL (Identical to Outboard side)			
3-026-3	52-113-300-006	1	BEARING (INBOARD)		2	3
3-025-3	52-239-562-001A	1	BEARING HOUSING (INBOARD)			
3-904-9	CP-611-271-482	4	SCREW (BEARING HSG - INB, ELECTRIC)			
3-904-9	DJ0081	4	SCREW (BEARING HSG - INB, DIESEL)			
3-449-9	N/A	-	BAFFLE (INBOARD)			
3-449-9	N/A	-	BAFFLE SCREWS - IN- AND OUT-BOARD			
CASING						
2-001-0	52-116-918-521	1	CASING - 125# x 250#			
2-001-0	52-116-918-520	1	CASING - 250# x 250#			
2-001-0	52-116-918-501	1	CASING - 125# x 125#			
2-904-1	CP-611-314-613	14	CAPSCREW - CASING			
2-904-1	CP-611-314-617	4	CAPSCREW - CASING			
2-904-1	N/A	-	CAPSCREW - CASING			
2-904-1	CP-617-511-688	14	CAPSCREW - (H) CASING			
2-904-2	CP-617-511-690	4	CAPSCREW - (H) CASING			
2-904-3	N/A	-	CAPSCREW - (H) CASING			
0-952-0	52-127-292-502	1	SEAL PIPING			
2-916-1	CP-671-139-491	2	CASING TAPER PIN			
2-123-5	52-111-314-005	1	CASING GASKET - SUCTION	1	2	3
2-123-6	52-111-315-005	1	CASING GASKET - DISCHARGE	1	2	3



PARTS LIST - AC FIRE SERIES 8100 / MODEL 6x6x9F (1.500" Shaft)

REV 0
DEC 2024

Always provide serial numbers when ordering parts. Factory can backcheck pump is not a custom build

Wear Surfaces same both sides. Quantities shown are totals for both sides.

Packing assembly same both sides

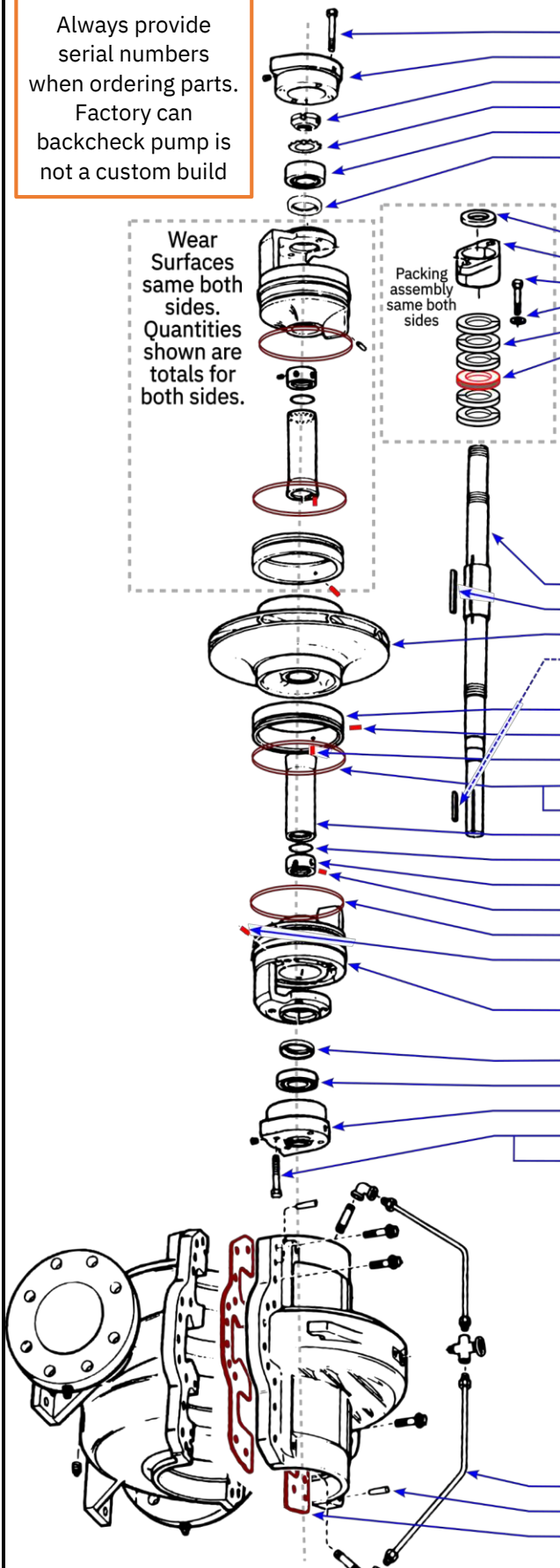

OUTBOARD BEARING ASSEMBLY				KITS		
Item No.	Part Number	Qty.	Description	1	2	3
3-904-9	CP-611-271-482	4	SCREW (BEARING HSG - OUT)			
3-025-4	52-239-563-001A	1	BEARING HOUSING (OUTBOARD)			
3-516-4	CP-819-111-206	1	LOCKNUT (BEARING)			
3-517-4	CP-819-133-206	1	LOCKWASHER (BEARING)			
3-026-4	CP-811-443-227	1	BEARING (OUTBOARD)		2	3
3-177-9	CP-753-030-535	1	LIP SEAL (same both sides)		2	3
3-449-9	52-261-625-001	1	BAFFLE (OUTBOARD)			
PACKING						
3-136-9	52-117-840-002	2	DEFLECTOR (Water Slinger)		2	3
1-014-9	52-224-259-501A	2	PACKING GLAND - HALF			
1-904-9	CP-611-327-472	4	GLAND SCREW	1	2	3
1-909-9	CP-651-001-214	4	GLAND WASHER	1	2	3
1-013-9	AC6128	12	SEAL CAGE (Lantern Ring) - OPTIONAL	1	2	3
1-924-9	52-430-298-017	2	PACKING RING	1	2	3
KITS - ITEMS INCLUDED WITH A KIT CANNOT BE ORDERED INDIVIDUALLY						
REPACK (1)	1DN203	-	REPACKING KIT	1		
MINOR (2)	1DN211	-	MINOR REPAIR KIT (INCLUDES REPACKING KIT)		2	
MAJOR (3)	1DN227	-	MAJOR REPAIR KIT (INCLUDES MINOR REPAIR KIT)			3
SHAFT AND IMPELLER						
3-000-7	AC2731	1	SHAFT - STEEL 1045			
3-911-1	CP-677-103-183	1	KEY (IMPELLER)			
4-002-0	52-460-754-001	1	IMPELLER			
3-911-2	AC0522	1	KEY (COUPLING)			
WEAR SURFACES (IDENTICAL BOTH SIDES)						
3-003-9	52-117-118-501	2	CASING WEAR RING ASSEMBLY			3
3-943-9	CP-671-181-371	2	SPIROL PIN (CASING RING)			
0-944-0	52-114-088-007	2	LOCKPIN (SHAFT SLEEVE)			
3-914-2	CP-751-531-932	2	O-RING (CASING RING)		2	3
3-914-2	N/A	-	O-RING (CASING RING)		2	3
3-009-9	52-239-536-501	2	SHAFT SLEEVE			3
3-914-9	CP-751-531-428	2	O-RING (SLEEVE)		2	3
3-015-9	CP-617-039-366	2	SHAFT NUT (SLEEVE)			3
3-902-3	52-128-640-001	2	SET SCREW (SHAFT NUT)			3
3-914-1	CP-751-531-264	2	O-RING (STUFF BOX)		2	3
3-943-9	CP-671-181-371	2	SPIROL PIN (STUFF BOX)			
-	AC6394	2	SPIROL BOX SHAFT GUARD			
3-073-9	52-460-715-501A	2	STUFF BOX ASSEMBLY W/ PIN			
INBOARD BEARING ASSEMBLY						
3-177-9	CP-753-030-535	1	LIP SEAL (Identical to Outboard side)			
3-026-3	52-113-300-006	1	BEARING (INBOARD)		2	3
3-025-3	52-239-562-001A	1	BEARING HOUSING (INBOARD)			
3-904-9	CP-611-271-482	4	SCREW (BEARING HSG - INB, ELECTRIC)			
3-904-9	DJ0081	4	SCREW (BEARING HSG - INB, DIESEL)			
3-449-9	52-261-625-002	1	BAFFLE (INBOARD)			
3-449-9	CP-615-106-461	4	BAFFLE SCREWS - IN- AND OUT-BOARD			
CASING						
2-001-0	52-460-808-521	1	CASING - 125# x 250#			
2-001-0	52-460-808-520	1	CASING - 250# x 250#			
2-001-0	52-460-808-501	1	CASING - 125# x 125#			
2-904-1	CP-611-314-615	14	CAPSCREW - CASING			
2-904-1	J92017	4	CAPSCREW - CASING			
2-904-1	N/A	-	CAPSCREW - CASING			
2-904-1	CP-617-511-688	14	CAPSCREW - (H) CASING			
2-904-2	CP-617-511-691	4	CAPSCREW - (H) CASING			
2-904-3	N/A	-	CAPSCREW - (H) CASING			
0-952-0	52-127-292-502	1	SEAL PIPING			
2-916-1	CP-671-139-491	2	CASING TAPER PIN			
2-123-5	52-360-258-005	1	CASING GASKET - SUCTION	1	2	3
2-123-6	52-360-259-005	1	CASING GASKET - DISCHARGE	1	2	3

PARTS LIST - AC FIRE SERIES 8100 / MODEL 8x6x9F (1.500" Shaft)

REV 0
DEC 2024

Always provide serial numbers when ordering parts. Factory can backcheck pump is not a custom build

Wear Surfaces same both sides. Quantities shown are totals for both sides.

Packing assembly same both sides

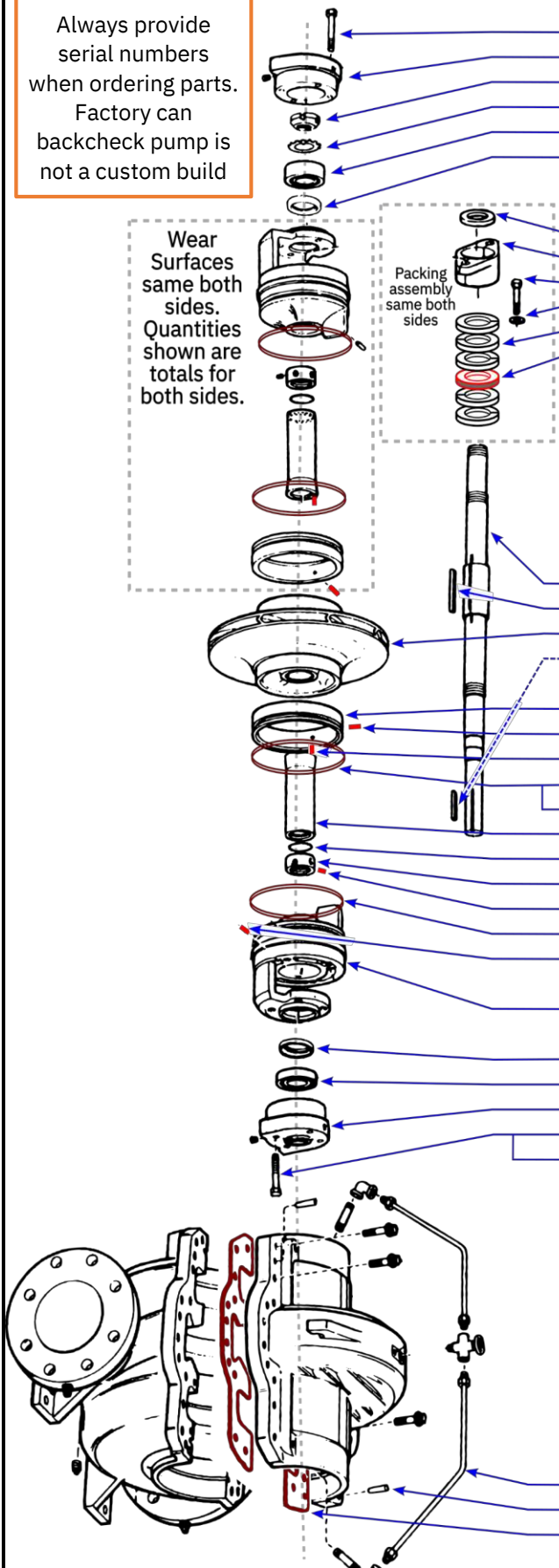

OUTBOARD BEARING ASSEMBLY				KITS		
Item No.	Part Number	Qty.	Description	1	2	3
3-904-9	CP-611-271-482	4	SCREW (BEARING HSG - OUT)			
3-025-4	52-239-563-001A	1	BEARING HOUSING (OUTBOARD)			
3-516-4	CP-819-111-206	1	LOCKNUT (BEARING)			
3-517-4	CP-819-133-206	1	LOCKWASHER (BEARING)			
3-026-4	CP-811-443-227	1	BEARING (OUTBOARD)		2	3
3-177-9	CP-753-030-535	1	LIP SEAL (same both sides)		2	3
3-449-9	52-261-625-001	1	BAFFLE (OUTBOARD)			
PACKING						
3-136-9	52-117-840-002	2	DEFLECTOR (Water Slinger)		2	3
1-014-9	52-224-259-501A	2	PACKING GLAND - HALF			
1-904-9	CP-611-327-472	4	GLAND SCREW	1	2	3
1-909-9	CP-651-001-214	4	GLAND WASHER	1	2	3
1-013-9	AC6128	12	SEAL CAGE (Lantern Ring) - OPTIONAL	1	2	3
1-924-9	52-430-298-017	2	PACKING RING	1	2	3
KITS - ITEMS INCLUDED WITH A KIT CANNOT BE ORDERED INDIVIDUALLY						
REPACK (1)	1DN203	-	REPACKING KIT	1		
MINOR (2)	1DN211	-	MINOR REPAIR KIT (INCLUDES REPACKING KIT)		2	
MAJOR (3)	1DN231	-	MAJOR REPAIR KIT (INCLUDES MINOR REPAIR KIT)			3
SHAFT AND IMPELLER						
3-000-7	52-239-345-008	1	SHAFT - STEEL 1045			
3-911-1	CP-677-103-183	1	KEY (IMPELLER)			
4-002-0	52-460-717-001	1	IMPELLER			
3-911-2	AC0522	1	KEY (COUPLING)			
WEAR SURFACES (IDENTICAL BOTH SIDES)						
3-003-9	52-117-117-501	2	CASING WEAR RING ASSEMBLY			3
3-943-9	CP-671-181-371	2	SPIROL PIN (CASING RING)			
0-944-0	52-114-088-007	2	LOCKPIN (SHAFT SLEEVE)			
3-914-2	CP-751-531-937	2	O-RING (CASING RING)		2	3
3-914-2	N/A	-	O-RING (CASING RING)		2	3
3-009-9	52-239-536-501	2	SHAFT SLEEVE			3
3-914-9	CP-751-531-428	2	O-RING (SLEEVE)		2	3
3-015-9	CP-617-039-366	2	SHAFT NUT (SLEEVE)			3
3-902-3	52-128-640-001	2	SET SCREW (SHAFT NUT)			3
3-914-1	CP-751-531-264	2	O-RING (STUFF BOX)		2	3
3-943-9	CP-671-181-371	2	SPIROL PIN (STUFF BOX)			
-	AC6394	2	SPIROL BOX SHAFT GUARD			
3-073-9	52-460-715-501A	2	STUFF BOX ASSEMBLY W/ PIN			
INBOARD BEARING ASSEMBLY						
3-177-9	CP-753-030-535	1	LIP SEAL (Identical to Outboard side)			
3-026-3	52-113-300-006	1	BEARING (INBOARD)		2	3
3-025-3	52-239-562-001A	1	BEARING HOUSING (INBOARD)			
3-904-9	CP-611-271-482	4	SCREW (BEARING HSG - INB, ELECTRIC)			
3-904-9	DJ0081	4	SCREW (BEARING HSG - INB, DIESEL)			
3-449-9	52-261-625-002	1	BAFFLE (INBOARD)			
3-449-9	CP-615-106-461	4	BAFFLE SCREWS - IN- AND OUT-BOARD			
CASING						
2-001-0	52-460-761-522	1	CASING - 125# x 250#			
2-001-0	52-460-761-520	1	CASING - 250# x 250#			
2-001-0	52-460-761-501	1	CASING - 125# x 125#			
2-904-1	CP-611-314-615	14	CAPSCREW - CASING			
2-904-1	J92017	4	CAPSCREW - CASING			
2-904-1	N/A	-	CAPSCREW - CASING			
2-904-1	CP-617-511-688	14	CAPSCREW - (H) CASING			
2-904-2	CP-617-511-691	4	CAPSCREW - (H) CASING			
2-904-3	N/A	-	CAPSCREW - (H) CASING			
0-952-0	52-127-292-502	1	SEAL PIPING			
2-916-1	CP-671-139-491	2	CASING TAPER PIN			
2-123-5	52-260-219-005	1	CASING GASKET - SUCTION	1	2	3
2-123-6	52-260-220-005	1	CASING GASKET - DISCHARGE	1	2	3



PARTS LIST - AC FIRE SERIES 8100 / MODEL 8x6x10F (1.875" Shaft)

REV 0
DEC 2024

Always provide serial numbers when ordering parts. Factory can backcheck pump is not a custom build

Wear Surfaces same both sides. Quantities shown are totals for both sides.

Packing assembly same both sides

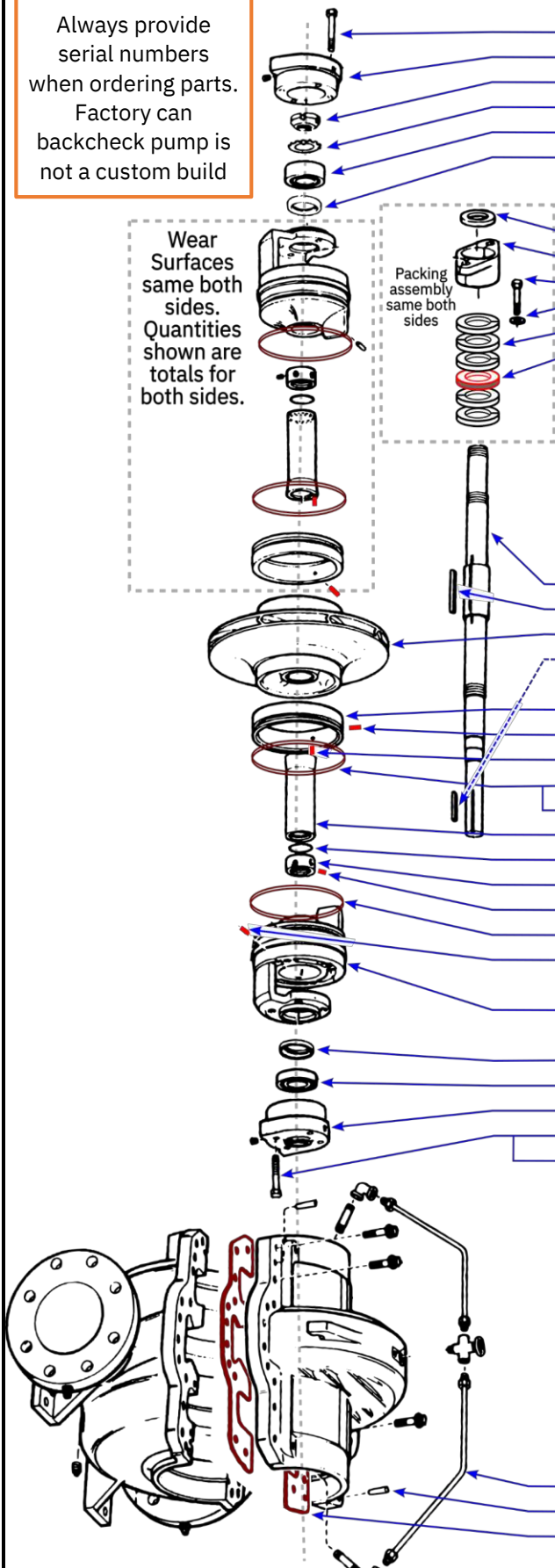

OUTBOARD BEARING ASSEMBLY				KITS		
Item No.	Part Number	Qty.	Description	1	2	3
3-904-9	CP-611-271-484	4	SCREW (BEARING HSG - OUT)			
3-025-4	52-239-567-001A	1	BEARING HOUSING (OUTBOARD)			
3-516-4	CP-819-111-207	1	LOCKNUT (BEARING)			
3-517-4	CP-819-133-207	1	LOCKWASHER (BEARING)			
3-026-4	CP-811-443-269	1	BEARING (OUTBOARD)		2	3
3-177-9	CP-753-030-907	1	LIP SEAL (same both sides)		2	3
3-449-9	52-260-399-001	1	BAFFLE (OUTBOARD)			
PACKING						
3-136-9	52-108-475-009	2	DEFLECTOR (Water Slinger)		2	3
1-014-9	08-104-772-501A	2	PACKING GLAND - HALF			
1-904-9	CP-611-327-552	4	GLAND SCREW	1	2	3
1-909-9	AC1502	4	GLAND WASHER	1	2	3
1-013-9	AC6129	12	SEAL CAGE (Lantern Ring) - OPTIONAL	1	2	3
1-924-9	52-430-298-028	2	PACKING RING	1	2	3
KITS - ITEMS INCLUDED WITH A KIT CANNOT BE ORDERED INDIVIDUALLY						
REPACK (1)	1DN204	-	REPACKING KIT	1		
MINOR (2)	1DN211	-	MINOR REPAIR KIT (INCLUDES REPACKING KIT)		2	
MAJOR (3)	1DN228	-	MAJOR REPAIR KIT (INCLUDES MINOR REPAIR KIT)			3
SHAFT AND IMPELLER						
3-000-7	52-239-343-005	1	SHAFT - STEEL 1045			
3-911-1	CP-677-051-146	1	KEY (IMPELLER)			
4-002-0	52-460-832-001	1	IMPELLER			
3-911-2	CP-677-103-191	1	KEY (COUPLING)			
WEAR SURFACES (IDENTICAL BOTH SIDES)						
3-003-9	52-160-158-501	2	CASING WEAR RING ASSEMBLY			3
3-943-9	CP-671-181-371	2	SPIROL PIN (CASING RING)			
0-944-0	52-114-088-007	2	LOCKPIN (SHAFT SLEEVE)			
3-914-2	CP-751-531-996	2	O-RING (CASING RING)		2	3
3-914-2	N/A	-	O-RING (CASING RING)		2	3
3-009-9	52-239-534-501	2	SHAFT SLEEVE			3
3-914-9	AC0545	2	O-RING (SLEEVE)		2	3
3-015-9	CP-617-039-366	2	SHAFT NUT (SLEEVE)			3
3-902-3	52-128-641-001	2	SET SCREW (SHAFT NUT)			3
3-914-1	CP-751-531-264	2	O-RING (STUFF BOX)		2	3
3-943-9	CP-671-181-371	2	SPIROL PIN (STUFF BOX)			
-	AC6395	2	SPIROL BOX SHAFT GUARD			
3-073-9	52-460-877-501A	2	STUFF BOX ASSEMBLY W/ PIN			
INBOARD BEARING ASSEMBLY						
3-177-9	CP-753-030-907	1	LIP SEAL (Identical to Outboard side)			
3-026-3	CP-811-005-293	1	BEARING (INBOARD)		2	3
3-025-3	52-239-566-001A	1	BEARING HOUSING (INBOARD)			
3-904-9	CP-611-271-484	4	SCREW (BEARING HSG - INB, ELECTRIC)			
3-904-9	CP-611-271-482	4	SCREW (BEARING HSG - INB, DIESEL)			
3-449-9	52-260-399-001	1	BAFFLE (INBOARD)			
3-449-9	52-260-399-001	1	BAFFLE SCREWS - IN- AND OUT-BOARD			
CASING						
2-001-0	52-460-849-520	1	CASING - 125# x 250#			
2-001-0	52-460-849-501	1	CASING - 250# x 250#			
2-001-0	52-260-269-005	1	CASING - 125# x 125#			
2-904-1	J92017	4	CAPSCREW - CASING			
2-904-1	N/A	-	CAPSCREW - CASING			
2-904-1	N/A	-	CAPSCREW - CASING			
2-904-1	CP-611-314-615	16	CAPSCREW - (H) CASING			
2-904-2	CP-617-511-691	4	CAPSCREW - (H) CASING			
2-904-3	N/A	-	CAPSCREW - (H) CASING			
0-952-0	52-127-292-502	1	SEAL PIPING			
2-916-1	CP-671-139-491	2	CASING TAPER PIN			
2-123-5	52-260-270-005	1	CASING GASKET - SUCTION	1	2	3
2-123-6	CP-617-511-688	16	CASING GASKET - DISCHARGE	1	2	3



PARTS LIST - AC FIRE SERIES 8100 / MODEL 8x6x12F-M (1.875" Shaft)

REV 0
DEC 2024

Always provide serial numbers when ordering parts. Factory can backcheck pump is not a custom build

Wear Surfaces same both sides. Quantities shown are totals for both sides.

Packing assembly same both sides

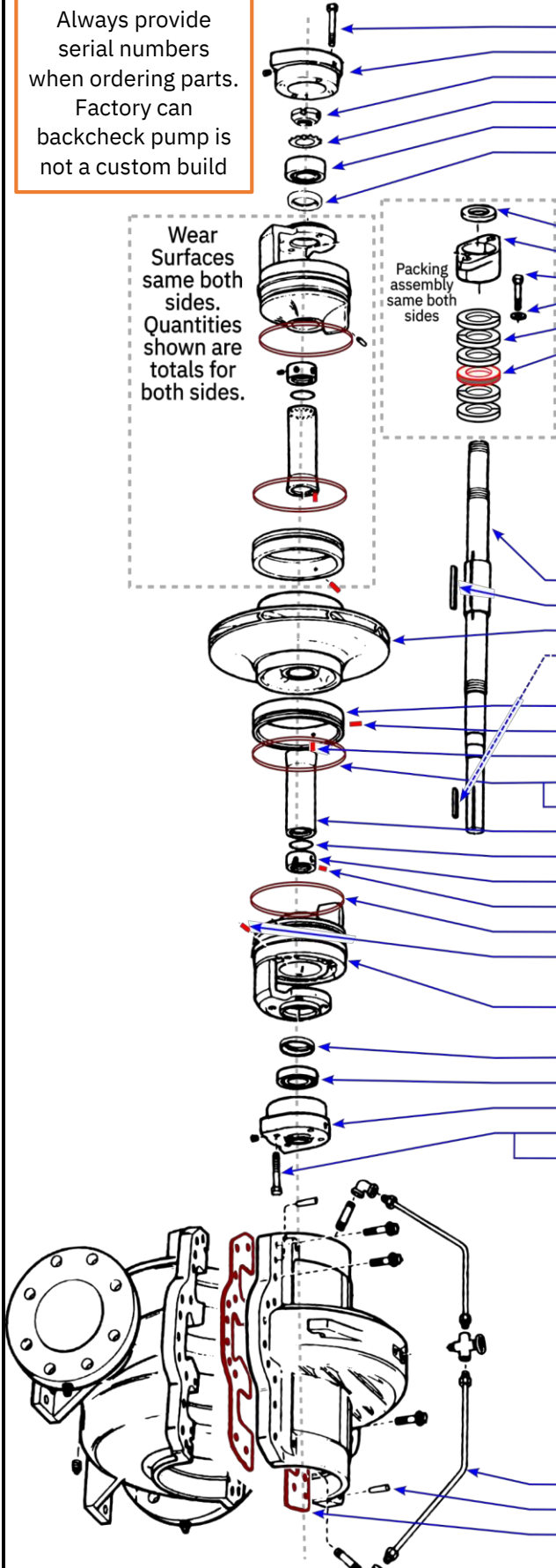

OUTBOARD BEARING ASSEMBLY				KITS		
Item No.	Part Number	Qty.	Description	1	2	3
3-904-9	CP-611-271-484	4	SCREW (BEARING HSG - OUT)			
3-025-4	52-239-567-001A	1	BEARING HOUSING (OUTBOARD)			
3-516-4	CP-819-111-207	1	LOCKNUT (BEARING)			
3-517-4	CP-819-133-207	1	LOCKWASHER (BEARING)			
3-026-4	CP-811-443-269	1	BEARING (OUTBOARD)		2	3
3-177-9	CP-753-030-907	1	LIP SEAL (same both sides)		2	3
3-449-9	N/A	-	BAFFLE (OUTBOARD)			
PACKING						
3-136-9	52-108-475-009	2	DEFLECTOR (Water Slinger)		2	3
1-014-9	08-104-772-501A	2	PACKING GLAND - HALF			
1-904-9	CP-611-327-552	4	GLAND SCREW	1	2	3
1-909-9	AC1502	4	GLAND WASHER	1	2	3
1-013-9	AC6129	12	SEAL CAGE (Lantern Ring) - OPTIONAL	1	2	3
1-924-9	52-430-298-028	2	PACKING RING	1	2	3
KITS - ITEMS INCLUDED WITH A KIT CANNOT BE ORDERED INDIVIDUALLY						
REPACK (1)	1DN204	-	REPACKING KIT	1		
MINOR (2)	1DN211	-	MINOR REPAIR KIT (INCLUDES REPACKING KIT)		2	
MAJOR (3)	1DN226	-	MAJOR REPAIR KIT (INCLUDES MINOR REPAIR KIT)			3
SHAFT AND IMPELLER						
3-000-7	52-239-343-005	1	SHAFT - STEEL 1045			
3-911-1	CP-677-051-146	1	KEY (IMPELLER)			
4-002-0	52-122-249-001	1	IMPELLER			
3-911-2	CP-677-103-191	1	KEY (COUPLING)			
WEAR SURFACES (IDENTICAL BOTH SIDES)						
3-003-9	52-117-117-501	2	CASING WEAR RING ASSEMBLY			3
3-943-9	CP-671-181-371	2	SPIROL PIN (CASING RING)			
0-944-0	52-114-088-007	2	LOCKPIN (SHAFT SLEEVE)			
3-914-2	CP-751-531-937	2	O-RING (CASING RING)		2	3
3-914-2	N/A	-	O-RING (CASING RING)		2	3
3-009-9	52-239-534-501	2	SHAFT SLEEVE			3
3-914-9	AC0545	2	O-RING (SLEEVE)		2	3
3-015-9	CP-617-039-366	2	SHAFT NUT (SLEEVE)			3
3-902-3	52-128-641-001	2	SET SCREW (SHAFT NUT)			3
3-914-1	CP-751-531-264	2	O-RING (STUFF BOX)		2	3
3-943-9	CP-671-181-371	2	SPIROL PIN (STUFF BOX)			
-	AC6395	2	SPIROL BOX SHAFT GUARD			
3-073-9	52-427-361-501A	2	STUFF BOX ASSEMBLY W/ PIN			
INBOARD BEARING ASSEMBLY						
3-177-9	CP-753-030-907	1	LIP SEAL (Identical to Outboard side)			
3-026-3	CP-811-005-293	1	BEARING (INBOARD)		2	3
3-025-3	52-239-566-001A	1	BEARING HOUSING (INBOARD)			
3-904-9	CP-611-271-484	4	SCREW (BEARING HSG - INB, ELECTRIC)			
3-904-9	CP-611-271-482	4	SCREW (BEARING HSG - INB, DIESEL)			
3-449-9	N/A	-	BAFFLE (INBOARD)			
3-449-9	N/A	-	BAFFLE SCREWS - IN- AND OUT-BOARD			
CASING						
2-001-0	52-116-920-524	1	CASING - 125# x 250#			
2-001-0	52-116-920-520	1	CASING - 250# x 250#			
2-001-0	52-116-920-501	1	CASING - 125# x 125#			
2-904-1	CP-611-314-615	14	CAPSCREW - CASING			
2-904-1	J92017	4	CAPSCREW - CASING			
2-904-1	N/A	-	CAPSCREW - CASING			
2-904-1	CP-617-511-688	14	CAPSCREW - (H) CASING			
2-904-2	CP-617-511-691	4	CAPSCREW - (H) CASING			
2-904-3	N/A	-	CAPSCREW - (H) CASING			
0-952-0	52-127-292-502	1	SEAL PIPING			
2-916-1	CP-671-139-491	2	CASING TAPER PIN			
2-123-5	52-111-310-005	1	CASING GASKET - SUCTION	1	2	3
2-123-6	52-111-311-005	1	CASING GASKET - DISCHARGE	1	2	3



PARTS LIST - AC FIRE SERIES 8100 / MODEL 8x6x12F-S (1.500" Shaft)

REV 0
DEC 2024

Always provide serial numbers when ordering parts. Factory can backcheck pump is not a custom build

Wear Surfaces same both sides. Quantities shown are totals for both sides.

Packing assembly same both sides

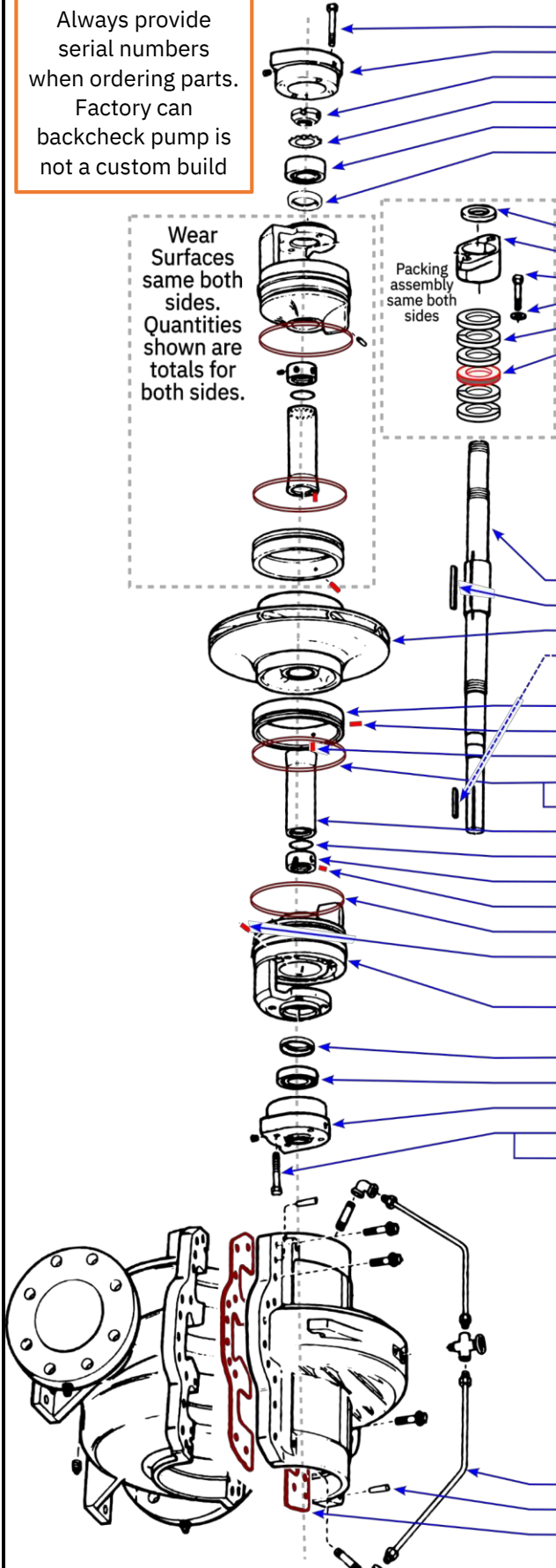

OUTBOARD BEARING ASSEMBLY				KITS		
Item No.	Part Number	Qty.	Description	1	2	3
3-904-9	CP-611-271-482	4	SCREW (BEARING HSG - OUT)			
3-025-4	52-239-563-001A	1	BEARING HOUSING (OUTBOARD)			
3-516-4	CP-819-111-206	1	LOCKNUT (BEARING)			
3-517-4	CP-819-133-206	1	LOCKWASHER (BEARING)			
3-026-4	CP-811-443-227	1	BEARING (OUTBOARD)		2	3
3-177-9	CP-753-030-535	1	LIP SEAL (same both sides)		2	3
3-449-9	N/A	-	BAFFLE (OUTBOARD)			
PACKING						
3-136-9	52-117-840-002	2	DEFLECTOR (Water Slinger)		2	3
1-014-9	52-224-259-501A	2	PACKING GLAND - HALF			
1-904-9	CP-611-327-472	4	GLAND SCREW	1	2	3
1-909-9	CP-651-001-214	4	GLAND WASHER	1	2	3
1-013-9	AC6128	12	SEAL CAGE (Lantern Ring) - OPTIONAL	1	2	3
1-924-9	52-430-298-017	2	PACKING RING	1	2	3
KITS - ITEMS INCLUDED WITH A KIT CANNOT BE ORDERED INDIVIDUALLY						
REPACK (1)	1DN204	-	REPACKING KIT	1		
MINOR (2)	1DN211	-	MINOR REPAIR KIT (INCLUDES REPACKING KIT)		2	
MAJOR (3)	1DN231	-	MAJOR REPAIR KIT (INCLUDES MINOR REPAIR KIT)			3
SHAFT AND IMPELLER						
3-000-7	52-239-345-008	1	SHAFT - STEEL 1045			
3-911-1	CP-677-103-183	1	KEY (IMPELLER)			
4-002-0	52-117-327-001	1	IMPELLER			
3-911-2	AC0522	1	KEY (COUPLING)			
WEAR SURFACES (IDENTICAL BOTH SIDES)						
3-003-9	52-117-117-501	2	CASING WEAR RING ASSEMBLY			3
3-943-9	CP-671-181-371	2	SPIROL PIN (CASING RING)			
0-944-0	52-114-088-007	2	LOCKPIN (SHAFT SLEEVE)			
3-914-2	CP-751-531-937	2	O-RING (CASING RING)		2	3
3-914-2	N/A	-	O-RING (CASING RING)		2	3
3-009-9	52-239-536-501	2	SHAFT SLEEVE			3
3-914-9	CP-751-531-428	2	O-RING (SLEEVE)		2	3
3-015-9	CP-617-039-366	2	SHAFT NUT (SLEEVE)			3
3-902-3	52-128-640-001	2	SET SCREW (SHAFT NUT)			3
3-914-1	CP-751-531-264	2	O-RING (STUFF BOX)		2	3
3-943-9	CP-671-181-371	2	SPIROL PIN (STUFF BOX)			
-	AC6394	2	SPIROL BOX SHAFT GUARD			
3-073-9	52-427-285-501A	2	STUFF BOX ASSEMBLY W/ PIN			
INBOARD BEARING ASSEMBLY						
3-177-9	CP-753-030-535	1	LIP SEAL (Identical to Outboard side)			
3-026-3	52-113-300-006	1	BEARING (INBOARD)		2	3
3-025-3	52-239-562-001A	1	BEARING HOUSING (INBOARD)			
3-904-9	CP-611-271-482	4	SCREW (BEARING HSG - INB, ELECTRIC)			
3-904-9	DJ0081	4	SCREW (BEARING HSG - INB, DIESEL)			
3-449-9	N/A	-	BAFFLE (INBOARD)			
3-449-9	N/A	-	BAFFLE SCREWS - IN- AND OUT-BOARD			
CASING						
2-001-0	52-116-920-524	1	CASING - 125# x 250#			
2-001-0	52-116-920-520	1	CASING - 250# x 250#			
2-001-0	52-116-920-501	1	CASING - 125# x 125#			
2-904-1	CP-611-314-615	18	CAPSCREW - CASING			
2-904-1	J92017	4	CAPSCREW - CASING			
2-904-1	N/A	-	CAPSCREW - CASING			
2-904-1	CP-617-511-688	18	CAPSCREW - (H) CASING			
2-904-2	CP-617-511-691	4	CAPSCREW - (H) CASING			
2-904-3	N/A	-	CAPSCREW - (H) CASING			
0-952-0	52-127-292-502	1	SEAL PIPING			
2-916-1	CP-671-139-491	2	CASING TAPER PIN			
2-123-5	52-111-310-005	1	CASING GASKET - SUCTION	1	2	3
2-123-6	52-111-311-005	1	CASING GASKET - DISCHARGE	1	2	3



PARTS LIST - AC FIRE SERIES 8100 / MODEL 8x6x13F (1.875" Shaft)

REV 0
DEC 2024

Always provide serial numbers when ordering parts. Factory can backcheck pump is not a custom build

Wear Surfaces same both sides. Quantities shown are totals for both sides.

Packing assembly same both sides

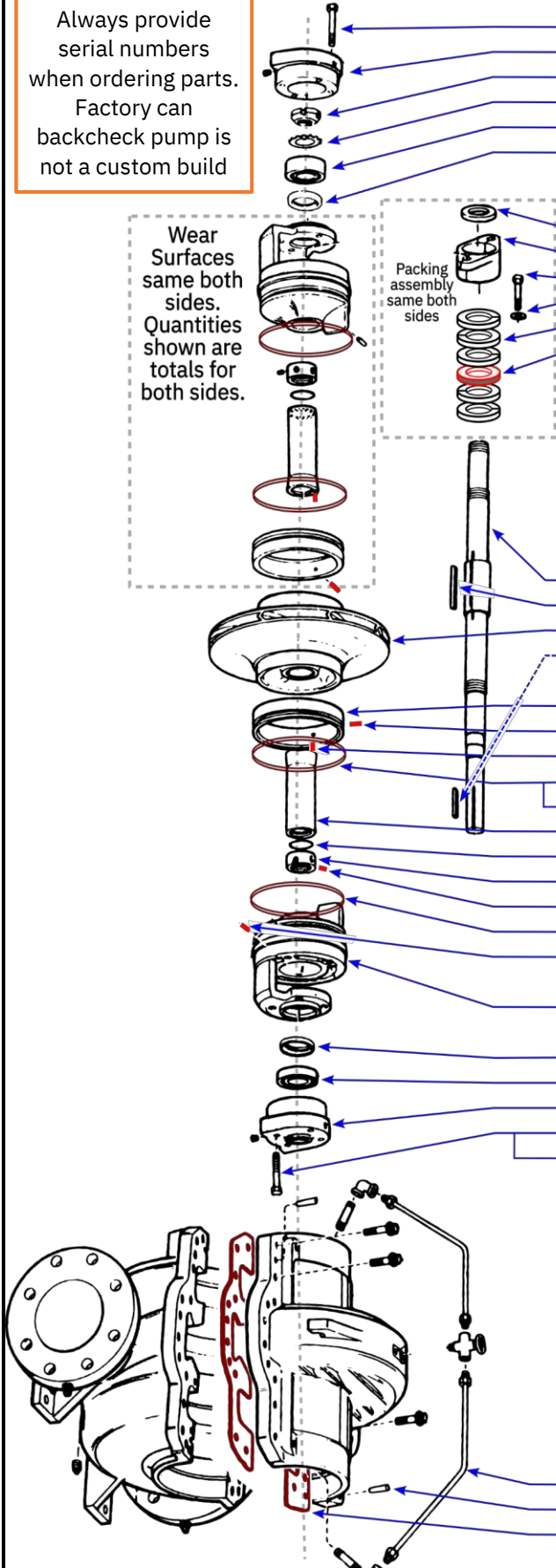

OUTBOARD BEARING ASSEMBLY				KITS		
Item No.	Part Number	Qty.	Description	1	2	3
3-904-9	CP-611-271-484	4	SCREW (BEARING HSG - OUT)			
3-025-4	52-239-567-001A	1	BEARING HOUSING (OUTBOARD)			
3-516-4	CP-819-111-207	1	LOCKNUT (BEARING)			
3-517-4	CP-819-133-207	1	LOCKWASHER (BEARING)			
3-026-4	CP-811-443-269	1	BEARING (OUTBOARD)		2	3
3-177-9	CP-753-030-907	1	LIP SEAL (same both sides)		2	3
3-449-9	N/A	-	BAFFLE (OUTBOARD)			
PACKING						
3-136-9	52-108-475-009	2	DEFLECTOR (Water Slinger)		2	3
1-014-9	08-104-772-501A	2	PACKING GLAND - HALF			
1-904-9	CP-611-327-552	4	GLAND SCREW	1	2	3
1-909-9	AC1502	4	GLAND WASHER	1	2	3
1-013-9	AC6129	12	SEAL CAGE (Lantern Ring) - OPTIONAL	1	2	3
1-924-9	52-430-298-028	2	PACKING RING	1	2	3
KITS - ITEMS INCLUDED WITH A KIT CANNOT BE ORDERED INDIVIDUALLY						
REPACK (1)	1DN204	-	REPACKING KIT	1		
MINOR (2)	1DN211	-	MINOR REPAIR KIT (INCLUDES REPACKING KIT)		2	
MAJOR (3)	1DN244	-	MAJOR REPAIR KIT (INCLUDES MINOR REPAIR KIT)			3
SHAFT AND IMPELLER						
3-000-7	52-239-347-005	1	SHAFT - STEEL 1045			
3-911-1	CP-677-051-153	1	KEY (IMPELLER)			
4-002-0	08-105-173-065	1	IMPELLER			
3-911-2	CP-677-103-191	1	KEY (COUPLING)			
WEAR SURFACES (IDENTICAL BOTH SIDES)						
3-003-9	08-104-599-507	2	CASING WEAR RING ASSEMBLY			3
3-943-9	CP-671-181-371	2	SPIROL PIN (CASING RING)			
0-944-0	52-114-088-007	2	LOCKPIN (SHAFT SLEEVE)			
3-914-2	CP-751-531-940	2	O-RING (CASING RING)		2	3
3-914-2	N/A	-	O-RING (CASING RING)		2	3
3-009-9	52-239-534-501	2	SHAFT SLEEVE			3
3-914-9	AC0545	2	O-RING (SLEEVE)		2	3
3-015-9	CP-617-039-366	2	SHAFT NUT (SLEEVE)			3
3-902-3	52-128-641-001	2	SET SCREW (SHAFT NUT)			3
3-914-1	CP-751-531-268	2	O-RING (STUFF BOX)		2	3
3-943-9	CP-671-181-371	2	SPIROL PIN (STUFF BOX)			
-	AC6397	2	SPIROL BOX SHAFT GUARD			
3-073-9	52-427-242-501A	2	STUFF BOX ASSEMBLY W/ PIN			
INBOARD BEARING ASSEMBLY						
3-177-9	CP-753-030-907	1	LIP SEAL (Identical to Outboard side)			
3-026-3	CP-811-005-293	1	BEARING (INBOARD)		2	3
3-025-3	52-239-566-001A	1	BEARING HOUSING (INBOARD)			
3-904-9	CP-611-271-484	4	SCREW (BEARING HSG - INB, ELECTRIC)			
3-904-9	CP-611-271-482	4	SCREW (BEARING HSG - INB, DIESEL)			
3-449-9	N/A	-	BAFFLE (INBOARD)			
3-449-9	N/A	-	BAFFLE SCREWS - IN- AND OUT-BOARD			
CASING						
2-001-0	52-118-401-521	1	CASING - 125# x 250#			
2-001-0	52-118-401-520	1	CASING - 250# x 250#			
2-001-0	52-118-401-501	1	CASING - 125# x 125#			
2-904-1	CP-611-314-615	20	CAPSCREW - CASING			
2-904-1	J92017	4	CAPSCREW - CASING			
2-904-1	N/A	-	CAPSCREW - CASING			
2-904-1	CP-617-511-688	20	CAPSCREW - (H) CASING			
2-904-2	CP-617-511-691	4	CAPSCREW - (H) CASING			
2-904-3	N/A	-	CAPSCREW - (H) CASING			
0-952-0	52-127-292-502	1	SEAL PIPING			
2-916-1	CP-671-139-491	2	CASING TAPER PIN			
2-123-5	52-122-059-005	1	CASING GASKET - SUCTION	1	2	3
2-123-6	52-122-060-005	1	CASING GASKET - DISCHARGE	1	2	3



PARTS LIST - AC FIRE SERIES 8100 / MODEL 8x6x18F (1.875" Shaft)

REV 0
DEC 2024

Always provide serial numbers when ordering parts. Factory can backcheck pump is not a custom build

Wear Surfaces same both sides. Quantities shown are totals for both sides.

Packing assembly same both sides

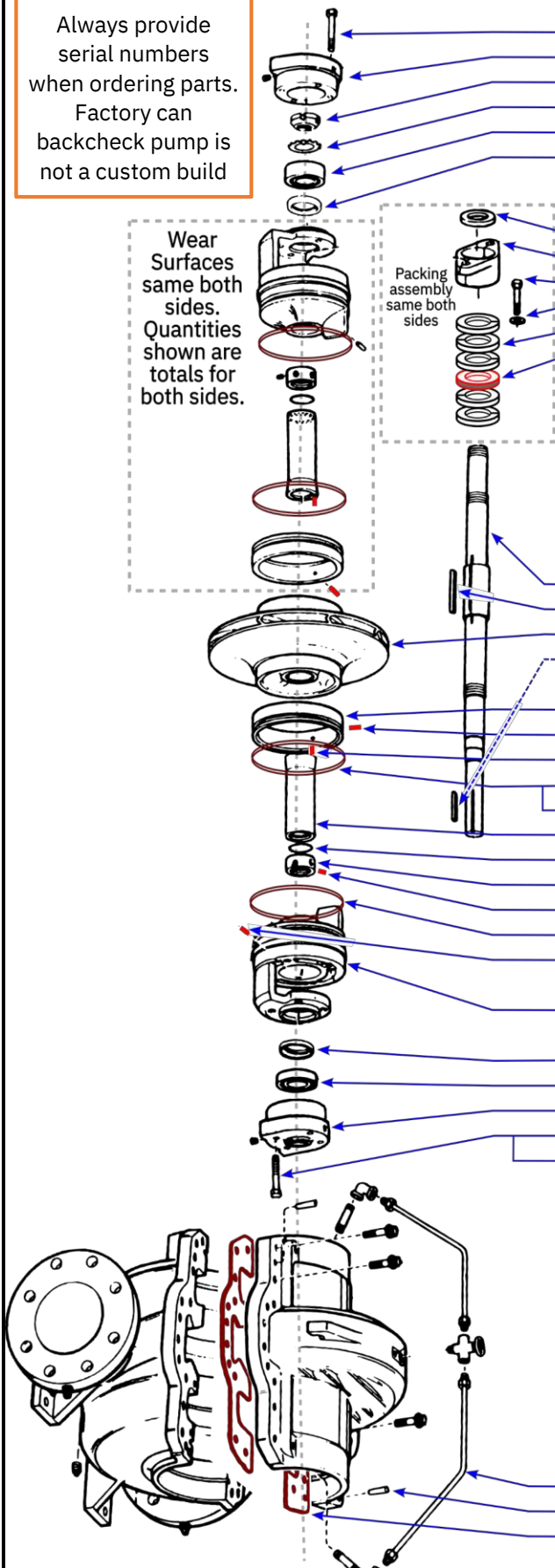

OUTBOARD BEARING ASSEMBLY				KITS		
Item No.	Part Number	Qty.	Description	1	2	3
3-904-9	CP-611-271-484	4	SCREW (BEARING HSG - OUT)			
3-025-4	52-239-567-001A	1	BEARING HOUSING (OUTBOARD)			
3-516-4	CP-819-111-207	1	LOCKNUT (BEARING)			
3-517-4	CP-819-133-207	1	LOCKWASHER (BEARING)			
3-026-4	CP-811-443-269	1	BEARING (OUTBOARD)		2	3
3-177-9	CP-753-030-907	1	LIP SEAL (same both sides)		2	3
3-449-9	N/A	-	BAFFLE (OUTBOARD)			
PACKING						
3-136-9	52-108-475-009	2	DEFLECTOR (Water Slinger)		2	3
1-014-9	08-104-772-501A	2	PACKING GLAND - HALF			
1-904-9	CP-611-327-552	4	GLAND SCREW	1	2	3
1-909-9	AC1502	4	GLAND WASHER	1	2	3
1-013-9	AC6129	12	SEAL CAGE (Lantern Ring) - OPTIONAL	1	2	3
1-924-9	52-430-298-028	2	PACKING RING	1	2	3
KITS - ITEMS INCLUDED WITH A KIT CANNOT BE ORDERED INDIVIDUALLY						
REPACK (1)	1DN204	-	REPACKING KIT	1		
MINOR (2)	1DN211	-	MINOR REPAIR KIT (INCLUDES REPACKING KIT)		2	
MAJOR (3)	1DN230	-	MAJOR REPAIR KIT (INCLUDES MINOR REPAIR KIT)			3
SHAFT AND IMPELLER						
3-000-7	52-239-347-005	1	SHAFT - STEEL 1045			
3-911-1	CP-677-051-153	1	KEY (IMPELLER)			
4-002-0	52-460-766-000	1	IMPELLER			
3-911-2	CP-677-103-191	1	KEY (COUPLING)			
WEAR SURFACES (IDENTICAL BOTH SIDES)						
3-003-9	52-160-143-501	2	CASING WEAR RING ASSEMBLY			3
3-943-9	CP-671-181-371	2	SPIROL PIN (CASING RING)			
0-944-0	52-114-088-007	2	LOCKPIN (SHAFT SLEEVE)			
3-914-2	CP-751-531-996	2	O-RING (CASING RING)		2	3
3-914-2	N/A	-	O-RING (CASING RING)		2	3
3-009-9	52-239-534-501	2	SHAFT SLEEVE			3
3-914-9	AC0545	2	O-RING (SLEEVE)		2	3
3-015-9	CP-617-039-366	2	SHAFT NUT (SLEEVE)			3
3-902-3	52-128-641-001	2	SET SCREW (SHAFT NUT)			3
3-914-1	CP-751-531-268	2	O-RING (STUFF BOX)		2	3
3-943-9	CP-671-181-371	2	SPIROL PIN (STUFF BOX)			
-	AC6397	2	SPIROL BOX SHAFT GUARD			
3-073-9	52-427-242-501A	2	STUFF BOX ASSEMBLY W/ PIN			
INBOARD BEARING ASSEMBLY						
3-177-9	CP-753-030-907	1	LIP SEAL (Identical to Outboard side)			
3-026-3	CP-811-005-293	1	BEARING (INBOARD)		2	3
3-025-3	52-239-566-001A	1	BEARING HOUSING (INBOARD)			
3-904-9	CP-611-271-484	4	SCREW (BEARING HSG - INB, ELECTRIC)			
3-904-9	CP-611-271-482	4	SCREW (BEARING HSG - INB, DIESEL)			
3-449-9	N/A	-	BAFFLE (INBOARD)			
3-449-9	N/A	-	BAFFLE SCREWS - IN- AND OUT-BOARD			
CASING						
2-001-0	52-129-440-521	1	CASING - 125# x 250#			
2-001-0	52-129-440-520	1	CASING - 250# x 250#			
2-001-0	52-129-440-501	1	CASING - 125# x 125#			
2-904-1	CP-611-314-615	26	CAPSCREW - CASING			
2-904-1	J92017	4	CAPSCREW - CASING			3
2-904-1	N/A	-	CAPSCREW - CASING			
2-904-1	CP-617-511-688	26	CAPSCREW - (H) CASING			
2-904-2	CP-617-511-691	4	CAPSCREW - (H) CASING			
2-904-3	N/A	-	CAPSCREW - (H) CASING			
0-952-0	52-127-292-502	1	SEAL PIPING			
2-916-1	CP-671-139-491	2	CASING TAPER PIN			
2-123-5	52-122-061-005	1	CASING GASKET - SUCTION	1	2	3
2-123-6	52-122-062-005	1	CASING GASKET - DISCHARGE	1	2	3

PARTS LIST - AC FIRE SERIES 8100 / MODEL 8x8x12F (1.875" Shaft)

REV 0
DEC 2024

Always provide serial numbers when ordering parts. Factory can backcheck pump is not a custom build

Wear Surfaces same both sides. Quantities shown are totals for both sides.

Packing assembly same both sides

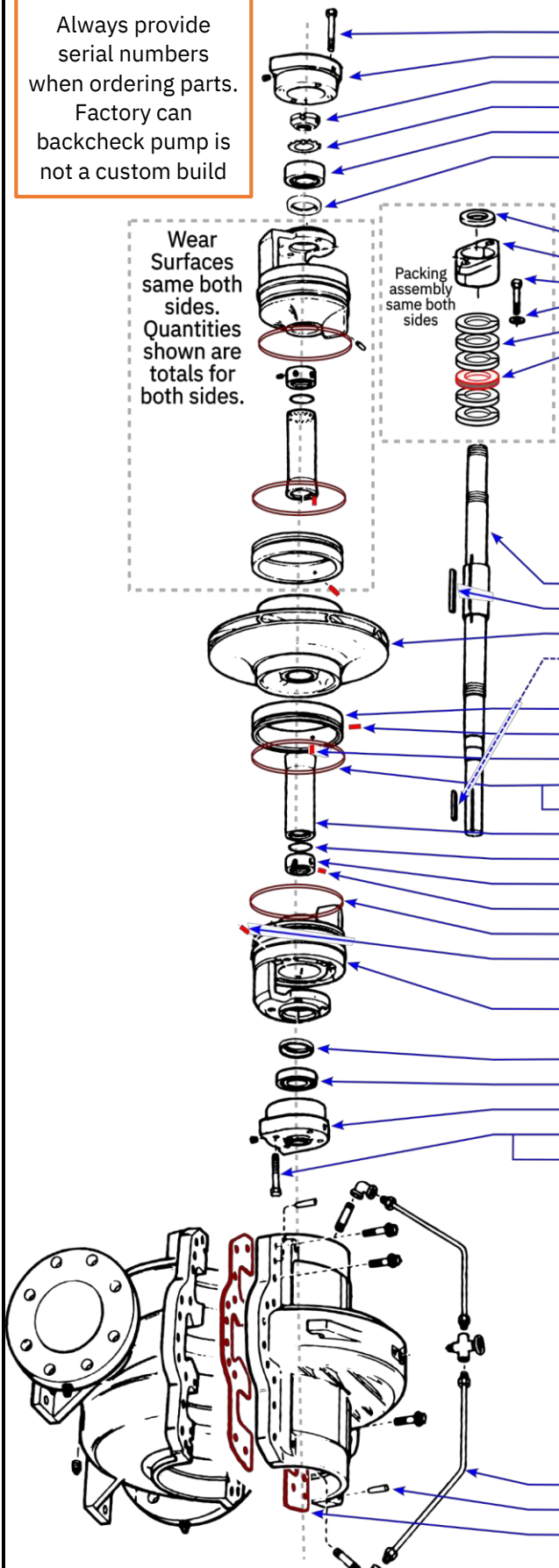

OUTBOARD BEARING ASSEMBLY				KITS		
Item No.	Part Number	Qty.	Description	1	2	3
3-904-9	CP-611-271-484	4	SCREW (BEARING HSG - OUT)			
3-025-4	52-239-567-001A	1	BEARING HOUSING (OUTBOARD)			
3-516-4	CP-819-111-207	1	LOCKNUT (BEARING)			
3-517-4	CP-819-133-207	1	LOCKWASHER (BEARING)			
3-026-4	CP-811-443-269	1	BEARING (OUTBOARD)		2	3
3-177-9	CP-753-030-907	1	LIP SEAL (same both sides)		2	3
3-449-9	N/A	-	BAFFLE (OUTBOARD)			
PACKING						
3-136-9	52-108-475-009	2	DEFLECTOR (Water Slinger)		2	3
1-014-9	08-104-772-501A	2	PACKING GLAND - HALF			
1-904-9	CP-611-327-552	4	GLAND SCREW	1	2	3
1-909-9	AC1502	4	GLAND WASHER	1	2	3
1-013-9	AC6129	12	SEAL CAGE (Lantern Ring) - OPTIONAL	1	2	3
1-924-9	52-430-298-028	2	PACKING RING	1	2	3
KITS - ITEMS INCLUDED WITH A KIT CANNOT BE ORDERED INDIVIDUALLY						
REPACK (1)	1DN204	-	REPACKING KIT	1		
MINOR (2)	1DN211	-	MINOR REPAIR KIT (INCLUDES REPACKING KIT)		2	
MAJOR (3)	1DN254	-	MAJOR REPAIR KIT (INCLUDES MINOR REPAIR KIT)			3
SHAFT AND IMPELLER						
3-000-7	52-239-347-005	1	SHAFT - STEEL 1045			
3-911-1	CP-677-051-153	1	KEY (IMPELLER)			
4-002-0	08-105-084-001	1	IMPELLER			
3-911-2	CP-677-103-191	1	KEY (COUPLING)			
WEAR SURFACES (IDENTICAL BOTH SIDES)						
3-003-9	08-104-599-501	2	CASING WEAR RING ASSEMBLY			3
3-943-9	CP-671-181-371	2	SPIROL PIN (CASING RING)			
0-944-0	52-114-088-007	2	LOCKPIN (SHAFT SLEEVE)			
3-914-2	CP-751-531-944	2	O-RING (CASING RING)		2	3
3-914-2	N/A	-	O-RING (CASING RING)		2	3
3-009-9	52-239-534-501	2	SHAFT SLEEVE			3
3-914-9	AC0545	2	O-RING (SLEEVE)		2	3
3-015-9	CP-617-039-366	2	SHAFT NUT (SLEEVE)			3
3-902-3	52-128-641-001	2	SET SCREW (SHAFT NUT)			3
3-914-1	CP-751-531-268	2	O-RING (STUFF BOX)		2	3
3-943-9	CP-671-181-371	2	SPIROL PIN (STUFF BOX)			
-	AC6397	2	SPIROL BOX SHAFT GUARD			
3-073-9	52-427-242-501A	2	STUFF BOX ASSEMBLY W/ PIN			
INBOARD BEARING ASSEMBLY						
3-177-9	CP-753-030-907	1	LIP SEAL (Identical to Outboard side)			
3-026-3	CP-811-005-293	1	BEARING (INBOARD)		2	3
3-025-3	52-239-566-001A	1	BEARING HOUSING (INBOARD)			
3-904-9	CP-611-271-484	4	SCREW (BEARING HSG - INB, ELECTRIC)			
3-904-9	CP-611-271-482	4	SCREW (BEARING HSG - INB, DIESEL)			
3-449-9	N/A	-	BAFFLE (INBOARD)			
3-449-9	N/A	-	BAFFLE SCREWS - IN- AND OUT-BOARD			
CASING						
2-001-0	AC6479	1	CASING - 125# x 250#			
2-001-0	52-116-968-520	1	CASING - 250# x 250#			
2-001-0	52-116-968-501	1	CASING - 125# x 125#			
2-904-1	CP-611-314-615	20	CAPSCREW - CASING			
2-904-1	J92017	4	CAPSCREW - CASING			
2-904-1	N/A	-	CAPSCREW - CASING			
2-904-1	CP-617-511-688	20	CAPSCREW - (H) CASING			
2-904-2	CP-617-511-691	4	CAPSCREW - (H) CASING			
2-904-3	N/A	-	CAPSCREW - (H) CASING			
0-952-0	52-127-292-502	1	SEAL PIPING			
2-916-1	CP-671-139-491	2	CASING TAPER PIN			
2-123-5	52-122-063-005	1	CASING GASKET - SUCTION	1	2	3
2-123-6	52-122-064-005	1	CASING GASKET - DISCHARGE	1	2	3

PARTS LIST - AC FIRE SERIES 8100 / MODEL 8x8x17F (2.375" Shaft)

REV 0
DEC 2024

Always provide serial numbers when ordering parts. Factory can backcheck pump is not a custom build

Wear Surfaces same both sides. Quantities shown are totals for both sides.

Packing assembly same both sides

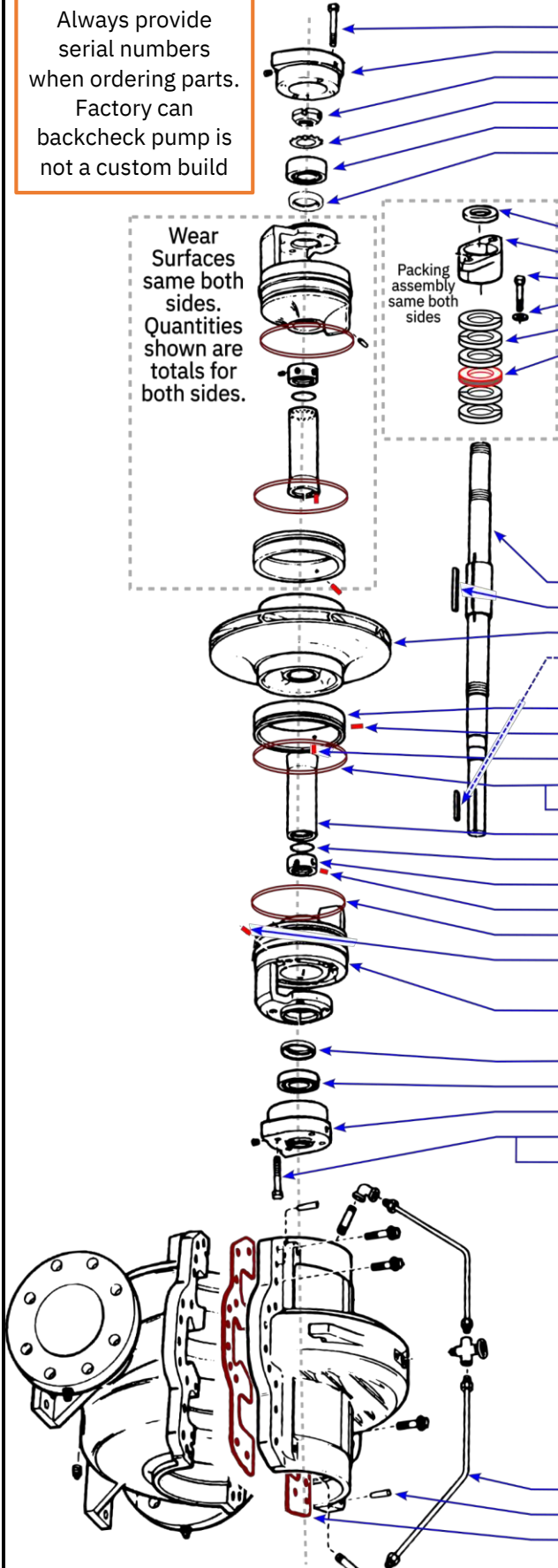

OUTBOARD BEARING ASSEMBLY				KITS		
Item No.	Part Number	Qty.	Description	1	2	3
3-904-9	CP-611-271-484	4	SCREW (BEARING HSG - OUT)			
3-025-4	52-239-571-001A	1	BEARING HOUSING (OUTBOARD)			
3-516-4	CP-819-111-208	1	LOCKNUT (BEARING)			
3-517-4	CP-819-133-208	1	LOCKWASHER (BEARING)			
3-026-4	CP-811-443-295	1	BEARING (OUTBOARD)		2	3
3-177-9	CP-753-383-021	1	LIP SEAL (same both sides)		2	3
3-449-9	N/A	-	BAFFLE (OUTBOARD)			
PACKING						
3-136-9	52-108-475-011	2	DEFLECTOR (Water Slinger)		2	3
1-014-9	08-104-771-501A	2	PACKING GLAND - HALF			
1-904-9	CP-611-327-552	4	GLAND SCREW	1	2	3
1-909-9	AC1502	4	GLAND WASHER	1	2	3
1-013-9	AC6130	12	SEAL CAGE (Lantern Ring) - OPTIONAL	1	2	3
1-924-9	52-430-298-027	2	PACKING RING	1	2	3
KITS - ITEMS INCLUDED WITH A KIT CANNOT BE ORDERED INDIVIDUALLY						
REPACK (1)	1DN205	-	REPACKING KIT	1		
MINOR (2)	1DN211	-	MINOR REPAIR KIT (INCLUDES REPACKING KIT)		2	
MAJOR (3)	1DN232	-	MAJOR REPAIR KIT (INCLUDES MINOR REPAIR KIT)			3
SHAFT AND IMPELLER						
3-000-7	52-239-349-005	1	SHAFT - STEEL 1045			
3-911-1	CP-677-051-246	1	KEY (IMPELLER)			
4-002-0	08-105-687-059	1	IMPELLER			
3-911-2	CP-677-103-238	1	KEY (COUPLING)			
WEAR SURFACES (IDENTICAL BOTH SIDES)						
3-003-9	08-104-599-507	2	CASING WEAR RING ASSEMBLY			3
3-943-9	CP-671-181-371	2	SPIROL PIN (CASING RING)			
0-944-0	52-114-088-007	2	LOCKPIN (SHAFT SLEEVE)			
3-914-2	CP-751-531-940	2	O-RING (CASING RING)		2	3
3-914-2	N/A	-	O-RING (CASING RING)		2	3
3-009-9	52-239-538-501	2	SHAFT SLEEVE			3
3-914-9	CP-751-531-442	2	O-RING (SLEEVE)		2	3
3-015-9	CP-617-039-366	2	SHAFT NUT (SLEEVE)			3
3-902-3	52-128-642-001	2	SET SCREW (SHAFT NUT)			3
3-914-1	CP-751-531-270	2	O-RING (STUFF BOX)		2	3
3-943-9	CP-671-181-371	2	SPIROL PIN (STUFF BOX)			
-	AC6398	2	SPIROL BOX SHAFT GUARD			
3-073-9	52-427-144-501A	2	STUFF BOX ASSEMBLY W/ PIN			
INBOARD BEARING ASSEMBLY						
3-177-9	CP-753-383-021	1	LIP SEAL (Identical to Outboard side)			
3-026-3	52-113-301-009	1	BEARING (INBOARD)		2	3
3-025-3	52-239-570-001A	1	BEARING HOUSING (INBOARD)			
3-904-9	DJ0083	4	SCREW (BEARING HSG - INB, ELECTRIC)			
3-904-9	CP-611-271-482	4	SCREW (BEARING HSG - INB, DIESEL)			
3-449-9	N/A	-	BAFFLE (INBOARD)			
3-449-9	N/A	-	BAFFLE SCREWS - IN- AND OUT-BOARD			
CASING						
2-001-0	52-116-922-521	1	CASING - 125# x 250#			
2-001-0	52-116-922-520	1	CASING - 250# x 250#			
2-001-0	52-116-922-501	1	CASING - 125# x 125#			
2-904-1	CP-611-314-615	26	CAPSCREW - CASING			
2-904-1	J92017	4	CAPSCREW - CASING			
2-904-1	N/A	-	CAPSCREW - CASING			
2-904-1	CP-617-511-688	26	CAPSCREW - (H) CASING			
2-904-2	CP-617-511-691	4	CAPSCREW - (H) CASING			
2-904-3	N/A	-	CAPSCREW - (H) CASING			
0-952-0	52-127-292-502	1	SEAL PIPING			
2-916-1	CP-671-139-491	2	CASING TAPER PIN			
2-123-5	52-122-065-005	1	CASING GASKET - SUCTION	1	2	3
2-123-6	52-122-066-005	1	CASING GASKET - DISCHARGE	1	2	3

PARTS LIST - AC FIRE SERIES 8100 / MODEL 10x8x17F-L (2.375" Shaft)

REV 0
DEC 2024

Always provide serial numbers when ordering parts. Factory can backcheck pump is not a custom build

Wear Surfaces same both sides. Quantities shown are totals for both sides.

Packing assembly same both sides

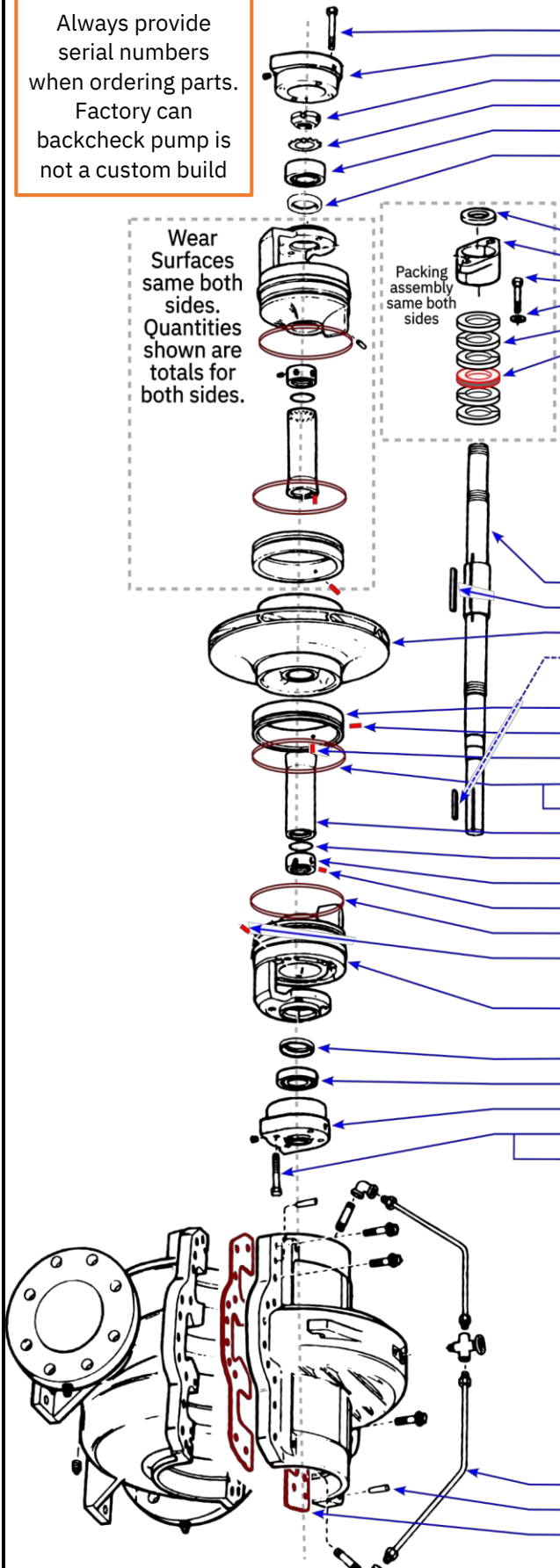

OUTBOARD BEARING ASSEMBLY				KITS		
Item No.	Part Number	Qty.	Description	1	2	3
3-904-9	CP-611-271-484	4	SCREW (BEARING HSG - OUT)			
3-025-4	52-239-570-001A	1	BEARING HOUSING (OUTBOARD)			
3-516-4	CP-819-111-208	1	LOCKNUT (BEARING)			
3-517-4	CP-819-133-208	1	LOCKWASHER (BEARING)			
3-026-4	CP-811-443-295	1	BEARING (OUTBOARD)		2	3
3-177-9	CP-753-383-021	1	LIP SEAL (same both sides)		2	3
3-449-9	N/A	-	BAFFLE (OUTBOARD)			
PACKING						
3-136-9	52-108-475-011	2	DEFLECTOR (Water Slinger)		2	3
1-014-9	08-104-771-501A	2	PACKING GLAND - HALF			
1-904-9	CP-611-327-552	4	GLAND SCREW	1	2	3
1-909-9	AC1502	4	GLAND WASHER	1	2	3
1-013-9	AC6130	12	SEAL CAGE (Lantern Ring) - OPTIONAL	1	2	3
1-924-9	52-430-298-027	2	PACKING RING	1	2	3
KITS - ITEMS INCLUDED WITH A KIT CANNOT BE ORDERED INDIVIDUALLY						
REPACK (1)	1DN205	-	REPACKING KIT	1		
MINOR (2)	1DN212	-	MINOR REPAIR KIT (INCLUDES REPACKING KIT)		2	
MAJOR (3)	1DN222	-	MAJOR REPAIR KIT (INCLUDES MINOR REPAIR KIT)			3
SHAFT AND IMPELLER						
3-000-7	52-239-349-005	1	SHAFT - STEEL 1045			
3-911-1	CP-677-051-246	1	KEY (IMPELLER)			
4-002-0	08-105-085-057	1	IMPELLER			
3-911-2	CP-677-103-238	1	KEY (COUPLING)			
WEAR SURFACES (IDENTICAL BOTH SIDES)						
3-003-9	08-104-599-501	2	CASING WEAR RING ASSEMBLY			3
3-943-9	CP-671-181-371	2	SPIROL PIN (CASING RING)			
0-944-0	52-114-088-007	2	LOCKPIN (SHAFT SLEEVE)			
3-914-2	CP-751-531-944	2	O-RING (CASING RING)		2	3
3-914-2	N/A	-	O-RING (CASING RING)		2	3
3-009-9	52-239-538-501	2	SHAFT SLEEVE			3
3-914-9	CP-751-531-442	2	O-RING (SLEEVE)		2	3
3-015-9	CP-617-039-366	2	SHAFT NUT (SLEEVE)			3
3-902-3	52-128-642-001	2	SET SCREW (SHAFT NUT)			3
3-914-1	CP-751-531-270	2	O-RING (STUFF BOX)		2	3
3-943-9	CP-671-181-371	2	SPIROL PIN (STUFF BOX)			
-	AC6398	2	SPIROL BOX SHAFT GUARD			
3-073-9	52-427-144-501A	2	STUFF BOX ASSEMBLY W/ PIN			
INBOARD BEARING ASSEMBLY						
3-177-9	CP-753-383-021	1	LIP SEAL (Identical to Outboard side)			
3-026-3	52-113-301-009	1	BEARING (INBOARD)		2	3
3-025-3	52-239-571-001A	1	BEARING HOUSING (INBOARD)			
3-904-9	DJ0083	4	SCREW (BEARING HSG - INB, ELECTRIC)			
3-904-9	CP-611-271-482	4	SCREW (BEARING HSG - INB, DIESEL)			
3-449-9	N/A	-	BAFFLE (INBOARD)			
3-449-9	N/A	-	BAFFLE SCREWS - IN- AND OUT-BOARD			
CASING						
2-001-0	52-116-924-521	1	CASING - 125# x 250#			
2-001-0	52-116-924-520	1	CASING - 250# x 250#			
2-001-0	52-116-924-501	1	CASING - 125# x 125#			
2-904-1	CP-611-314-615	20	CAPSCREW - CASING			
2-904-1	J92017	4	CAPSCREW - CASING			
2-904-1	CP-611-314-613	6	CAPSCREW - CASING			
2-904-1	CP-617-511-688	20	CAPSCREW - (H) CASING			
2-904-2	CP-617-511-691	4	CAPSCREW - (H) CASING			
2-904-3	CP-617-511-688	6	CAPSCREW - (H) CASING			
0-952-0	52-127-292-502	1	SEAL PIPING			
2-916-1	CP-671-139-491	2	CASING TAPER PIN			
2-123-5	52-122-069-005	1	CASING GASKET - SUCTION	1	2	3
2-123-6	52-122-070-005	1	CASING GASKET - DISCHARGE	1	2	3



PARTS LIST - AC FIRE SERIES 8100 / MODEL 10x8x17F-S (2.375" Shaft)

REV 0
DEC 2024

Always provide serial numbers when ordering parts. Factory can backcheck pump is not a custom build

Wear Surfaces same both sides. Quantities shown are totals for both sides.

Packing assembly same both sides

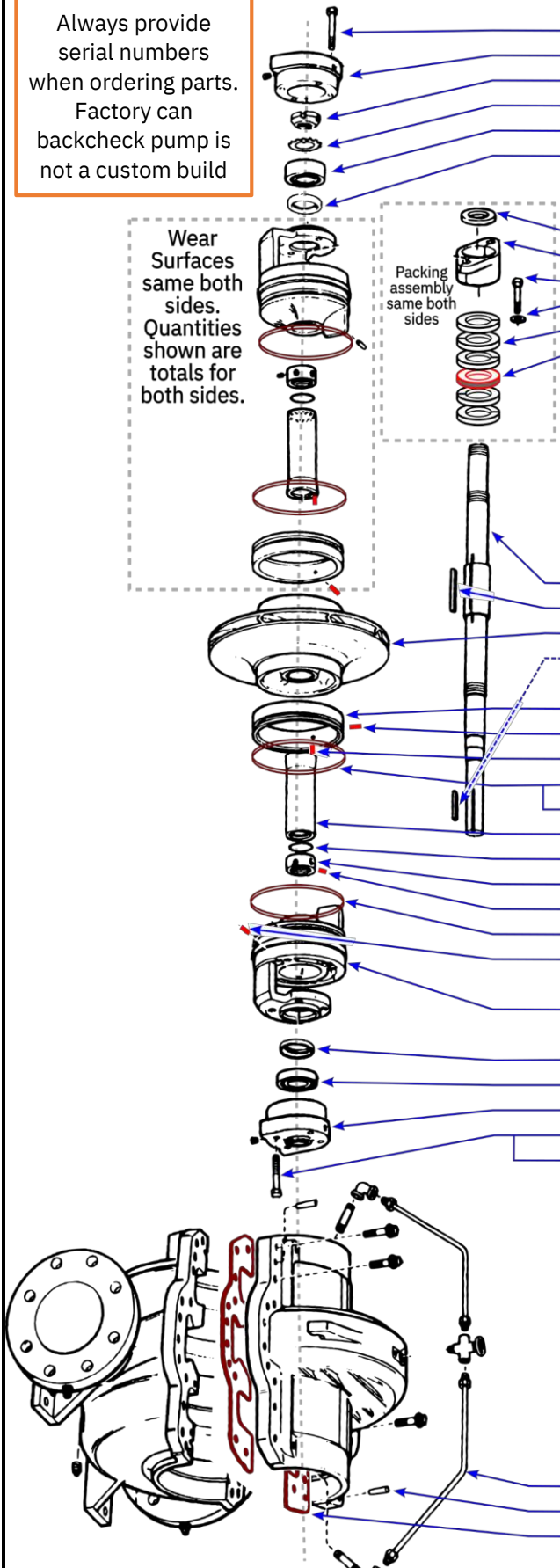

OUTBOARD BEARING ASSEMBLY				KITS		
Item No.	Part Number	Qty.	Description	1	2	3
3-904-9	CP-611-271-484	4	SCREW (BEARING HSG - OUT)			
3-025-4	52-239-570-001A	1	BEARING HOUSING (OUTBOARD)			
3-516-4	CP-819-111-208	1	LOCKNUT (BEARING)			
3-517-4	CP-819-133-208	1	LOCKWASHER (BEARING)			
3-026-4	CP-811-443-295	1	BEARING (OUTBOARD)		2	3
3-177-9	CP-753-383-021	1	LIP SEAL (same both sides)		2	3
3-449-9	N/A	-	BAFFLE (OUTBOARD)			
PACKING						
3-136-9	52-108-475-011	2	DEFLECTOR (Water Slinger)		2	3
1-014-9	08-104-771-501A	2	PACKING GLAND - HALF			
1-904-9	CP-611-327-552	4	GLAND SCREW	1	2	3
1-909-9	AC1502	4	GLAND WASHER	1	2	3
1-013-9	AC6130	12	SEAL CAGE (Lantern Ring) - OPTIONAL	1	2	3
1-924-9	52-430-298-027	2	PACKING RING	1	2	3
KITS - ITEMS INCLUDED WITH A KIT CANNOT BE ORDERED INDIVIDUALLY						
REPACK (1)	1DN205	-	REPACKING KIT	1		
MINOR (2)	1DN212	-	MINOR REPAIR KIT (INCLUDES REPACKING KIT)		2	
MAJOR (3)	1DN222	-	MAJOR REPAIR KIT (INCLUDES MINOR REPAIR KIT)			3
SHAFT AND IMPELLER						
3-000-7	52-239-349-005	1	SHAFT - STEEL 1045			
3-911-1	CP-677-051-246	1	KEY (IMPELLER)			
4-002-0	52-322-941-001	1	IMPELLER			
3-911-2	CP-677-103-238	1	KEY (COUPLING)			
WEAR SURFACES (IDENTICAL BOTH SIDES)						
3-003-9	08-104-599-501	2	CASING WEAR RING ASSEMBLY			3
3-943-9	CP-671-181-371	2	SPIROL PIN (CASING RING)			
0-944-0	52-114-088-007	2	LOCKPIN (SHAFT SLEEVE)			
3-914-2	CP-751-531-944	2	O-RING (CASING RING)		2	3
3-914-2	N/A	-	O-RING (CASING RING)		2	3
3-009-9	52-239-538-501	2	SHAFT SLEEVE			3
3-914-9	CP-751-531-442	2	O-RING (SLEEVE)		2	3
3-015-9	CP-617-039-366	2	SHAFT NUT (SLEEVE)			3
3-902-3	52-128-642-001	2	SET SCREW (SHAFT NUT)			3
3-914-1	CP-751-531-270	2	O-RING (STUFF BOX)		2	3
3-943-9	CP-671-181-371	2	SPIROL PIN (STUFF BOX)			
-	AC6398	2	SPIROL BOX SHAFT GUARD			
3-073-9	52-427-144-501A	2	STUFF BOX ASSEMBLY W/ PIN			
INBOARD BEARING ASSEMBLY						
3-177-9	CP-753-383-021	1	LIP SEAL (Identical to Outboard side)			
3-026-3	52-113-301-009	1	BEARING (INBOARD)		2	3
3-025-3	52-239-571-001A	1	BEARING HOUSING (INBOARD)			
3-904-9	DJ0083	4	SCREW (BEARING HSG - INB, ELECTRIC)			
3-904-9	CP-611-271-482	4	SCREW (BEARING HSG - INB, DIESEL)			
3-449-9	N/A	-	BAFFLE (INBOARD)			
3-449-9	N/A	-	BAFFLE SCREWS - IN- AND OUT-BOARD			
CASING						
2-001-0	52-116-924-521	1	CASING - 125# x 250#			
2-001-0	52-116-924-520	1	CASING - 250# x 250#			
2-001-0	52-116-924-501	1	CASING - 125# x 125#			
2-904-1	CP-611-314-615	20	CAPSCREW - CASING			
2-904-1	J92017	4	CAPSCREW - CASING			
2-904-1	CP-611-314-613	6	CAPSCREW - CASING			
2-904-1	CP-617-511-688	20	CAPSCREW - (H) CASING			
2-904-2	CP-617-511-691	4	CAPSCREW - (H) CASING			
2-904-3	CP-617-511-688	6	CAPSCREW - (H) CASING			
0-952-0	52-127-292-502	1	SEAL PIPING			
2-916-1	CP-671-139-491	2	CASING TAPER PIN			
2-123-5	52-122-069-005	1	CASING GASKET - SUCTION	1	2	3
2-123-6	52-122-070-005	1	CASING GASKET - DISCHARGE	1	2	3



PARTS LIST - AC FIRE SERIES 8100 / MODEL 10x8x20F-L (2.375" Shaft)

REV 0
DEC 2024

Always provide serial numbers when ordering parts. Factory can backcheck pump is not a custom build

Wear Surfaces same both sides. Quantities shown are totals for both sides.

Packing assembly same both sides

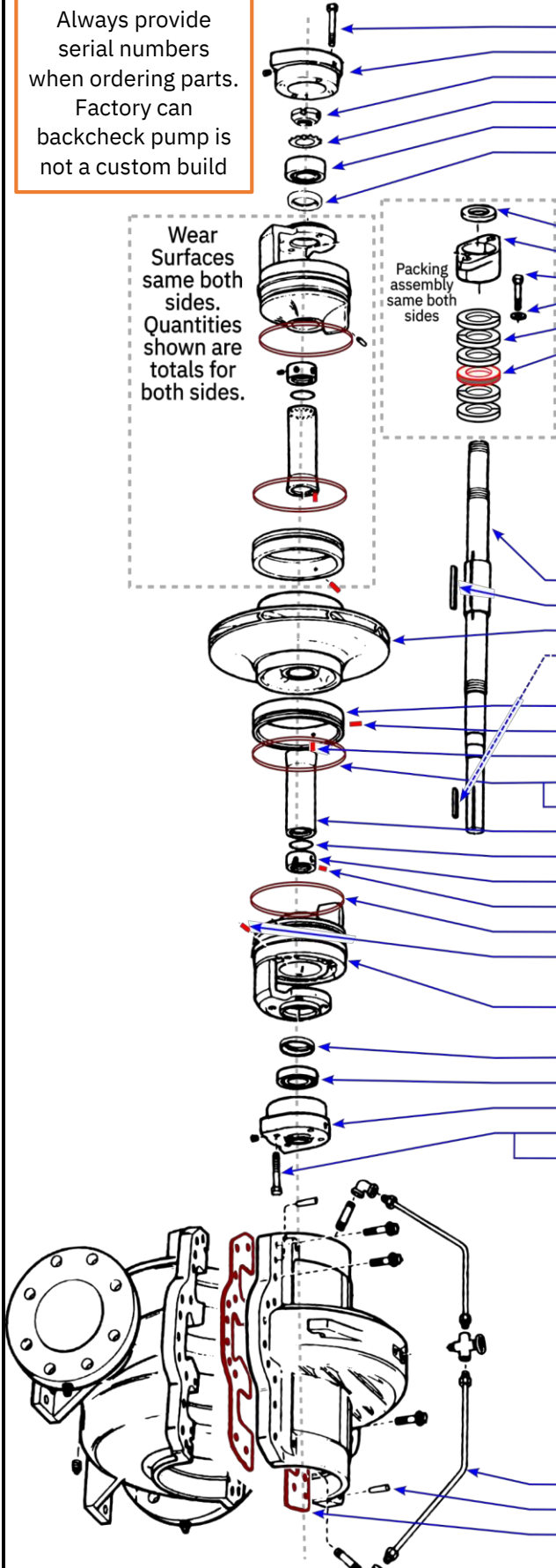

OUTBOARD BEARING ASSEMBLY				KITS		
Item No.	Part Number	Qty.	Description	1	2	3
3-904-9	CP-611-271-484	4	SCREW (BEARING HSG - OUT)			
3-025-4	52-239-570-001A	1	BEARING HOUSING (OUTBOARD)			
3-516-4	CP-819-111-208	1	LOCKNUT (BEARING)			
3-517-4	CP-819-133-208	1	LOCKWASHER (BEARING)			
3-026-4	CP-811-443-295	1	BEARING (OUTBOARD)		2	3
3-177-9	CP-753-383-021	1	LIP SEAL (same both sides)		2	3
3-449-9	52-260-537-001	1	BAFFLE (OUTBOARD)			
PACKING						
3-136-9	52-108-475-011	2	DEFLECTOR (Water Slinger)		2	3
1-014-9	08-104-771-501A	2	PACKING GLAND - HALF			
1-904-9	CP-611-327-552	4	GLAND SCREW	1	2	3
1-909-9	AC1502	4	GLAND WASHER	1	2	3
1-013-9	AC6130	12	SEAL CAGE (Lantern Ring) - OPTIONAL	1	2	3
1-924-9	52-430-298-027	2	PACKING RING	1	2	3
KITS - ITEMS INCLUDED WITH A KIT CANNOT BE ORDERED INDIVIDUALLY						
REPACK (1)	1DN205	-	REPACKING KIT	1		
MINOR (2)	1DN212	-	MINOR REPAIR KIT (INCLUDES REPACKING KIT)		2	
MAJOR (3)	1DN223	-	MAJOR REPAIR KIT (INCLUDES MINOR REPAIR KIT)			3
SHAFT AND IMPELLER						
3-000-7	52-239-349-005	1	SHAFT - STEEL 1045			
3-911-1	CP-677-051-246	1	KEY (IMPELLER)			
4-002-0	52-327-909-001	1	IMPELLER			
3-911-2	CP-677-103-238	1	KEY (COUPLING)			
WEAR SURFACES (IDENTICAL BOTH SIDES)						
3-003-9	52-328-631-501	2	CASING WEAR RING ASSEMBLY			3
3-943-9	CP-671-181-371	2	SPIROL PIN (CASING RING)			
0-944-0	52-114-088-007	2	LOCKPIN (SHAFT SLEEVE)			
3-914-2	CP-751-531-949	2	O-RING (CASING RING)		2	3
3-914-2	52-127-417-001	2	O-RING (CASING RING)		2	3
3-009-9	52-239-538-501	2	SHAFT SLEEVE			3
3-914-9	CP-751-531-442	2	O-RING (SLEEVE)		2	3
3-015-9	CP-617-039-366	2	SHAFT NUT (SLEEVE)			3
3-902-3	52-128-642-001	2	SET SCREW (SHAFT NUT)			3
3-914-1	CP-751-531-270	2	O-RING (STUFF BOX)		2	3
3-943-9	CP-671-181-371	2	SPIROL PIN (STUFF BOX)			
-	AC6399	2	SPIROL BOX SHAFT GUARD			
3-073-9	52-462-165-501	2	STUFF BOX ASSEMBLY W/ PIN			
INBOARD BEARING ASSEMBLY						
3-177-9	CP-753-383-021	1	LIP SEAL (Identical to Outboard side)			
3-026-3	52-113-301-009	1	BEARING (INBOARD)		2	3
3-025-3	52-239-571-001A	1	BEARING HOUSING (INBOARD)			
3-904-9	DJ0083	4	SCREW (BEARING HSG - INB, ELECTRIC)			
3-904-9	CP-611-271-482	4	SCREW (BEARING HSG - INB, DIESEL)			
3-449-9	52-260-537-001	1	BAFFLE (INBOARD)			
3-449-9	52-260-537-001	1	BAFFLE SCREWS - IN- AND OUT-BOARD			
CASING						
2-001-0	52-128-321-521	1	CASING - 125# x 250#			
2-001-0	52-128-321-520	1	CASING - 250# x 250#			
2-001-0	52-128-321-501	1	CASING - 125# x 125#			
2-904-1	CP-611-314-615	20	CAPSCREW - CASING			
2-904-1	J92017	16	CAPSCREW - CASING			
2-904-1	N/A	-	CAPSCREW - CASING			
2-904-1	CP-617-511-688	20	CAPSCREW - (H) CASING			
2-904-2	CP-617-511-691	16	CAPSCREW - (H) CASING			
2-904-3	N/A	-	CAPSCREW - (H) CASING			
0-952-0	52-127-292-502	1	SEAL PIPING			
2-916-1	CP-671-139-491	2	CASING TAPER PIN			
2-123-5	52-239-077-005	1	CASING GASKET - SUCTION	1	2	3
2-123-6	52-239-078-005	1	CASING GASKET - DISCHARGE	1	2	3



PARTS LIST - AC FIRE SERIES 8100 / MODEL 10x8x20F-S (2.375" Shaft)

REV 0
DEC 2024

Always provide serial numbers when ordering parts. Factory can backcheck pump is not a custom build

Wear Surfaces same both sides. Quantities shown are totals for both sides.

Packing assembly same both sides

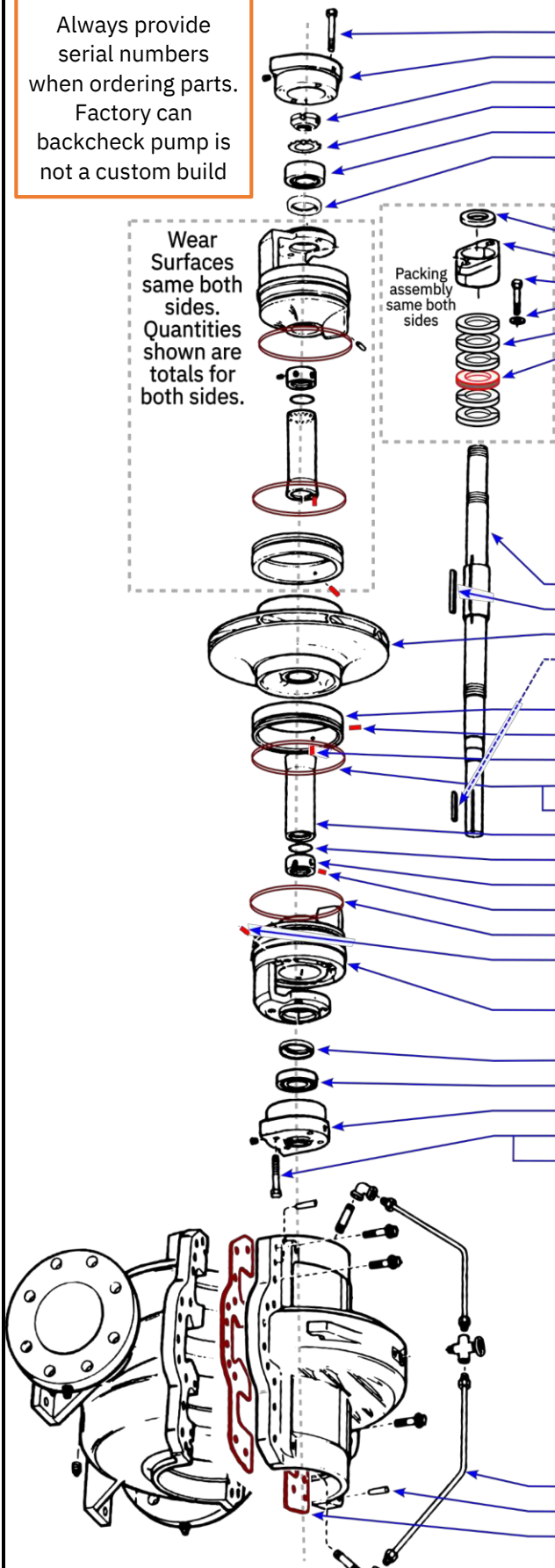

OUTBOARD BEARING ASSEMBLY				KITS		
Item No.	Part Number	Qty.	Description	1	2	3
3-904-9	CP-611-271-484	4	SCREW (BEARING HSG - OUT)			
3-025-4	52-239-570-001A	1	BEARING HOUSING (OUTBOARD)			
3-516-4	CP-819-111-208	1	LOCKNUT (BEARING)			
3-517-4	CP-819-133-208	1	LOCKWASHER (BEARING)			
3-026-4	CP-811-443-295	1	BEARING (OUTBOARD)		2	3
3-177-9	CP-753-383-021	1	LIP SEAL (same both sides)		2	3
3-449-9	52-260-537-001	1	BAFFLE (OUTBOARD)			
PACKING						
3-136-9	52-108-475-011	2	DEFLECTOR (Water Slinger)		2	3
1-014-9	08-104-771-501A	2	PACKING GLAND - HALF			
1-904-9	CP-611-327-552	4	GLAND SCREW	1	2	3
1-909-9	AC1502	4	GLAND WASHER	1	2	3
1-013-9	AC6130	12	SEAL CAGE (Lantern Ring) - OPTIONAL	1	2	3
1-924-9	52-430-298-027	2	PACKING RING	1	2	3
KITS - ITEMS INCLUDED WITH A KIT CANNOT BE ORDERED INDIVIDUALLY						
REPACK (1)	1DN205	-	REPACKING KIT	1		
MINOR (2)	1DN212	-	MINOR REPAIR KIT (INCLUDES REPACKING KIT)		2	
MAJOR (3)	1DN223	-	MAJOR REPAIR KIT (INCLUDES MINOR REPAIR KIT)			3
SHAFT AND IMPELLER						
3-000-7	52-239-349-005	1	SHAFT - STEEL 1045			
3-911-1	CP-677-051-246	1	KEY (IMPELLER)			
4-002-0	52-327-901-001	1	IMPELLER			
3-911-2	CP-677-103-238	1	KEY (COUPLING)			
WEAR SURFACES (IDENTICAL BOTH SIDES)						
3-003-9	52-328-631-501	2	CASING WEAR RING ASSEMBLY			3
3-943-9	CP-671-181-371	2	SPIROL PIN (CASING RING)			
0-944-0	52-114-088-007	2	LOCKPIN (SHAFT SLEEVE)			
3-914-2	CP-751-531-949	2	O-RING (CASING RING)		2	3
3-914-2	52-127-417-001	2	O-RING (CASING RING)		2	3
3-009-9	52-239-538-501	2	SHAFT SLEEVE			3
3-914-9	CP-751-531-442	2	O-RING (SLEEVE)		2	3
3-015-9	CP-617-039-366	2	SHAFT NUT (SLEEVE)			3
3-902-3	52-128-642-001	2	SET SCREW (SHAFT NUT)			3
3-914-1	CP-751-531-270	2	O-RING (STUFF BOX)		2	3
3-943-9	CP-671-181-371	2	SPIROL PIN (STUFF BOX)			
-	AC6399	2	SPIROL BOX SHAFT GUARD			
3-073-9	52-462-165-501	2	STUFF BOX ASSEMBLY W/ PIN			
INBOARD BEARING ASSEMBLY						
3-177-9	CP-753-383-021	1	LIP SEAL (Identical to Outboard side)			
3-026-3	52-113-301-009	1	BEARING (INBOARD)		2	3
3-025-3	52-239-571-001A	1	BEARING HOUSING (INBOARD)			
3-904-9	DJ0083	4	SCREW (BEARING HSG - INB, ELECTRIC)			
3-904-9	CP-611-271-482	4	SCREW (BEARING HSG - INB, DIESEL)			
3-449-9	52-260-537-001	1	BAFFLE (INBOARD)			
3-449-9	52-260-537-001	1	BAFFLE SCREWS - IN- AND OUT-BOARD			
CASING						
2-001-0	52-128-321-521	1	CASING - 125# x 250#			
2-001-0	52-128-321-520	1	CASING - 250# x 250#			
2-001-0	52-128-321-501	1	CASING - 125# x 125#			
2-904-1	CP-611-314-615	20	CAPSCREW - CASING			
2-904-1	J92017	16	CAPSCREW - CASING			
2-904-1	N/A	-	CAPSCREW - CASING			
2-904-1	CP-617-511-688	20	CAPSCREW - (H) CASING			
2-904-2	CP-617-511-691	16	CAPSCREW - (H) CASING			
2-904-3	N/A	-	CAPSCREW - (H) CASING			
0-952-0	52-127-292-502	1	SEAL PIPING			
2-916-1	CP-671-139-491	2	CASING TAPER PIN			
2-123-5	52-239-077-005	1	CASING GASKET - SUCTION	1	2	3
2-123-6	52-239-078-005	1	CASING GASKET - DISCHARGE	1	2	3



PARTS LIST - AC FIRE SERIES 8100 / MODEL 12x10x18F (2.375" Shaft)

REV 0
DEC 2024

Always provide serial numbers when ordering parts. Factory can backcheck pump is not a custom build

Wear Surfaces same both sides. Quantities shown are totals for both sides.

Packing assembly same both sides

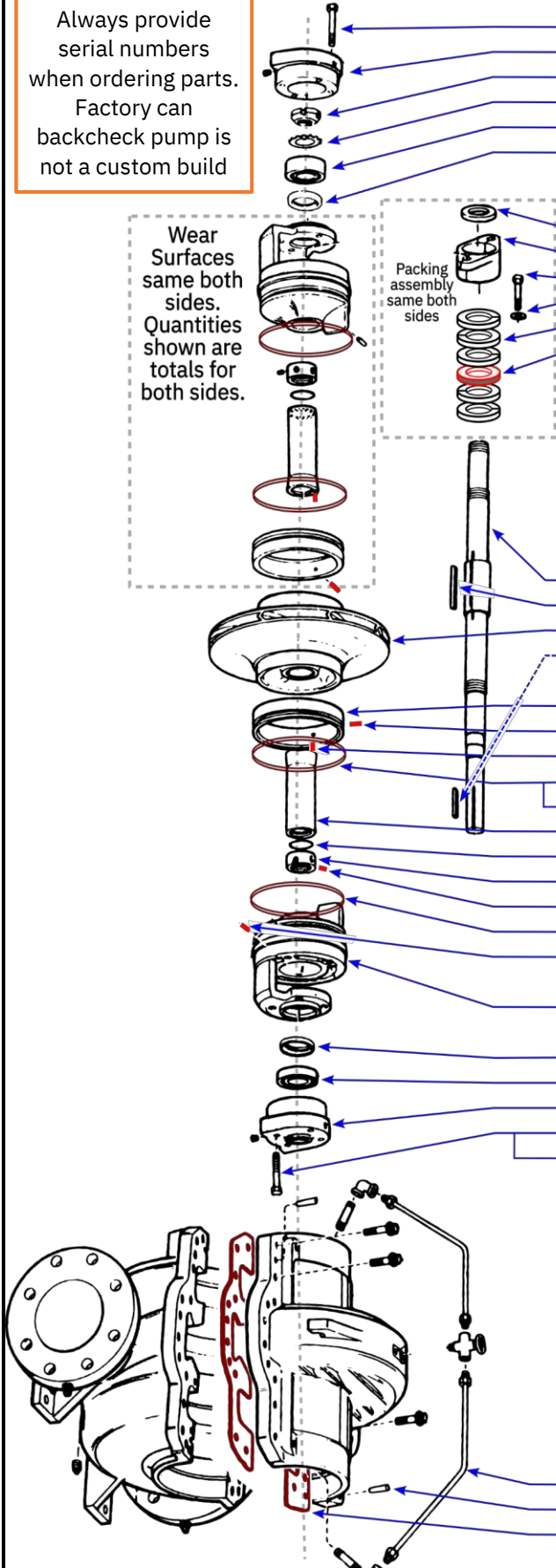

OUTBOARD BEARING ASSEMBLY				KITS		
Item No.	Part Number	Qty.	Description	1	2	3
3-904-9	CP-611-271-484	4	SCREW (BEARING HSG - OUT)			
3-025-4	52-239-570-001A	1	BEARING HOUSING (OUTBOARD)			
3-516-4	CP-819-111-208	1	LOCKNUT (BEARING)			
3-517-4	CP-819-133-208	1	LOCKWASHER (BEARING)			
3-026-4	CP-811-443-295	1	BEARING (OUTBOARD)		2	3
3-177-9	CP-753-383-021	1	LIP SEAL (same both sides)		2	3
3-449-9	N/A	-	BAFFLE (OUTBOARD)			
PACKING						
3-136-9	52-108-475-011	2	DEFLECTOR (Water Slinger)		2	3
1-014-9	08-104-771-501A	2	PACKING GLAND - HALF			
1-904-9	CP-611-327-552	4	GLAND SCREW	1	2	3
1-909-9	AC1502	4	GLAND WASHER	1	2	3
1-013-9	AC6130	12	SEAL CAGE (Lantern Ring) - OPTIONAL	1	2	3
1-924-9	52-430-298-027	2	PACKING RING	1	2	3
KITS - ITEMS INCLUDED WITH A KIT CANNOT BE ORDERED INDIVIDUALLY						
REPACK (1)	1DN205	-	REPACKING KIT	1		
MINOR (2)	N/A	-	MINOR REPAIR KIT (INCLUDES REPACKING KIT)		2	
MAJOR (3)	1DN224	-	MAJOR REPAIR KIT (INCLUDES MINOR REPAIR KIT)			3
SHAFT AND IMPELLER						
3-000-7	52-239-349-005	1	SHAFT - STEEL 1045			
3-911-1	CP-677-051-246	1	KEY (IMPELLER)			
4-002-0	52-460-473-000	1	IMPELLER			
3-911-2	CP-677-103-238	1	KEY (COUPLING)			
WEAR SURFACES (IDENTICAL BOTH SIDES)						
3-003-9	52-360-132-501	2	CASING WEAR RING ASSEMBLY			3
3-943-9	CP-671-181-371	2	SPIROL PIN (CASING RING)			
0-944-0	52-114-088-007	2	LOCKPIN (SHAFT SLEEVE)			
3-914-2	52-127-417-002	2	O-RING (CASING RING)		2	3
3-914-2	52-127-417-003	2	O-RING (CASING RING)		2	3
3-009-9	52-239-538-501	2	SHAFT SLEEVE			3
3-914-9	CP-751-531-442	2	O-RING (SLEEVE)		2	3
3-015-9	CP-617-039-366	2	SHAFT NUT (SLEEVE)			3
3-902-3	52-128-642-001	2	SET SCREW (SHAFT NUT)			3
3-914-1	CP-751-531-270	2	O-RING (STUFF BOX)		2	3
3-943-9	CP-671-181-371	2	SPIROL PIN (STUFF BOX)			
-	AC6398	2	SPIROL BOX SHAFT GUARD			
3-073-9	52-427-144-501A	2	STUFF BOX ASSEMBLY W/ PIN			
INBOARD BEARING ASSEMBLY						
3-177-9	CP-753-383-021	1	LIP SEAL (Identical to Outboard side)			
3-026-3	52-113-301-009	1	BEARING (INBOARD)		2	3
3-025-3	52-239-571-001A	1	BEARING HOUSING (INBOARD)			
3-904-9	DJ0083	4	SCREW (BEARING HSG - INB, ELECTRIC)			
3-904-9	CP-611-271-482	4	SCREW (BEARING HSG - INB, DIESEL)			
3-449-9	N/A	-	BAFFLE (INBOARD)			
3-449-9	N/A	-	BAFFLE SCREWS - IN- AND OUT-BOARD			
CASING						
2-001-0	52-160-090-501	1	CASING - 125# x 250#			
2-001-0	N/A	-	CASING - 250# x 250#			
2-001-0	52-160-090-520	1	CASING - 125# x 125#			
2-904-1	CP-611-314-615	16	CAPSCREW - CASING			
2-904-1	CP-611-314-613	16	CAPSCREW - CASING			
2-904-1	N/A	-	CAPSCREW - CASING			
2-904-1	CP-617-511-688	32	CAPSCREW - (H) CASING			
2-904-2	CP-617-511-691	4	CAPSCREW - (H) CASING			
2-904-3	N/A	-	CAPSCREW - (H) CASING			
0-952-0	52-127-292-502	1	SEAL PIPING			
2-916-1	CP-671-139-491	2	CASING TAPER PIN			
2-123-5	52-128-806-005	1	CASING GASKET - SUCTION	1	2	3
2-123-6	52-128-805-005	1	CASING GASKET - DISCHARGE	1	2	3